



# CALVARY CHAPEL

---

## CHEYENNE.CHURCH

July 2025

Dear Calvary Chapel Family,

As we continue pursuing the vision of Knowing Jesus, Serving Others, Sharing Life, and Discipling Others, I'm excited to share the latest updates on the building plan God is unfolding for us. God has faithfully been leading us in this journey of planning and provision, especially as it relates to our Calvary Kids program.

Our Building Team has been working closely with Five-R Co. to develop a plan that addresses the needs of our Calvary Kids area. As many of you know, the current setup is undersized, lacks a secure layout, is spread out across the building, and does not have dedicated restrooms. This new design addresses those challenges by creating a secure and centralized space for our children.

The updated plan includes a secure area with a centralized check-in and exclusive restrooms for children checked into Calvary Kids. A new corridor will connect the Multi-Use Room to the addition, with check-in stations and a staffed desk at the entrance to the secure zone. The Nursery and Toddler rooms will feature windows so parents can easily check in on their little ones.

We are incredibly thankful for your generosity to the Building Fund over the years. The cost of the Calvary Kids addition is \$2,082,250, and we currently have just over half of that amount through donations and set-aside funds. You can follow our fundraising progress on the thermometer display in the lobby or online at [www.cheyenne.church/build](http://www.cheyenne.church/build). The remaining funds will be financed at the conclusion of the building phase. If you'd like to contribute, you can do so at [www.cheyenne.church/give](http://www.cheyenne.church/give) by selecting "Building Project Fund - Calvary Chapel," or by using our designated building fund envelopes.

Please join us in prayer as we prepare to begin this exciting construction phase. Tentatively, construction is set to begin in August 2025, pending county approval of the building permits, and is expected to take approximately one year to complete.

In Christ,  
Pastor Doug

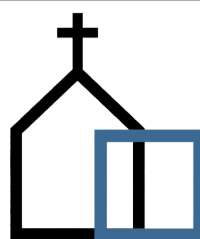

MAKING A PLACE TO  
**KNOW** JESUS,  
**SERVE** OTHERS,  
**SHARE** LIFE,  
**DISCIPLE** OTHERS



# FLOOR PLAN

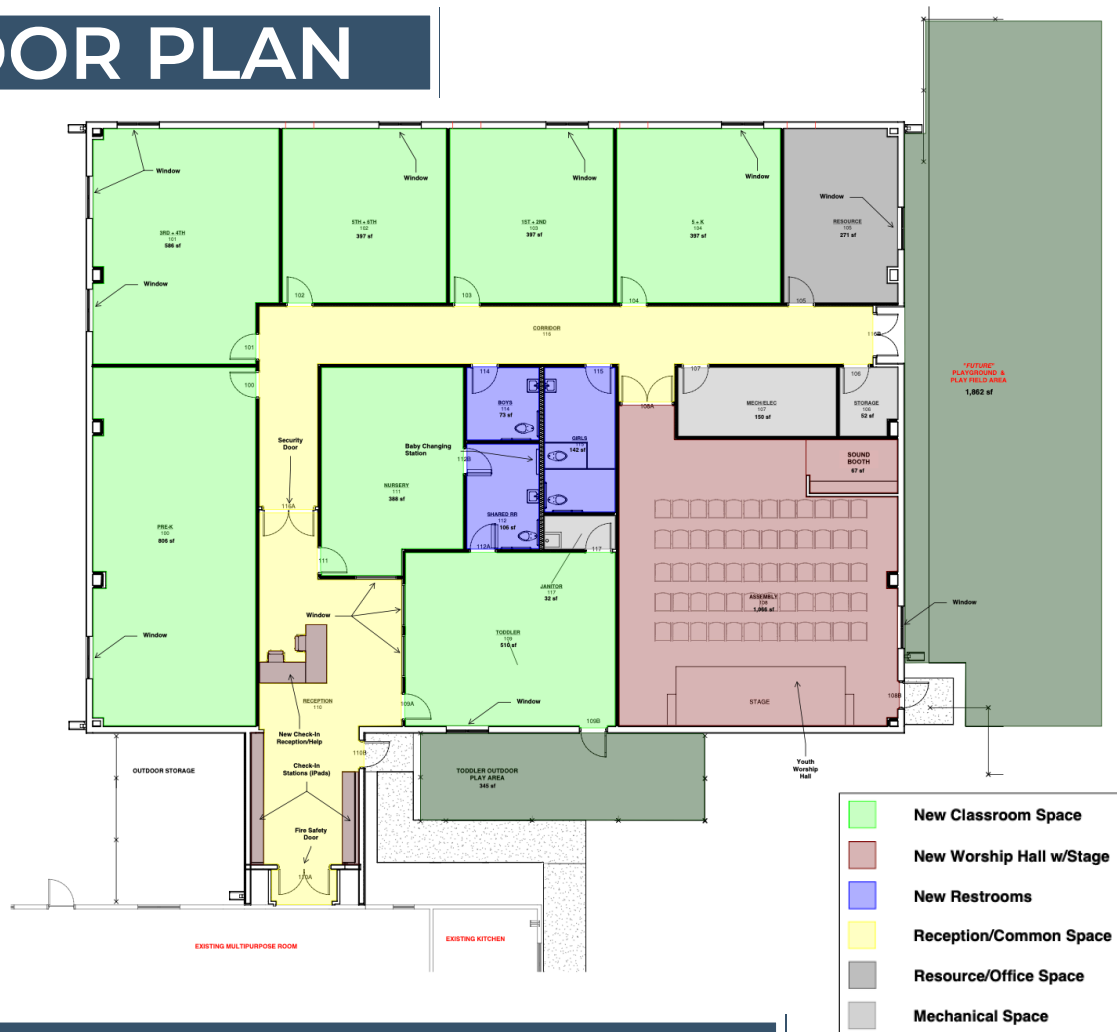

# EXTERIOR ELEVATION

