

Collide5/6 Summer Schedule

9:15 Service

9:25 - 9:30 AM: Arrival and Introduction

- Kids arrive and introduce yourself to help them settle in. Talk a little about today's topic and what to expect keep it really brief

9:30 – 9:35 AM: Worship

- Dedicated to worship time.

9:35 - 9:55 AM: Bible Story

- Bible story time varies anywhere from 10-17 minutes.

9:55ish - 10:00 AM: Sword Drill Time

- Encourage the kids to participate and play

10:00 - 10:25 AM: Craft Time

- Kids do the craft that relate to the Bible story or theme of the day.

10:25 AM: Dismissal

11:00 Service

11:10 - 11:15 AM: Arrival and Introduction

- Kids arrive and introduce yourself to help them settle in. Talk a little about today's topic and what to expect! (keep it brief)

11:15 – 11:20 AM: Worship

- Dedicated to worship time.

11:20 – 11:40 AM: Bible Story

- Bible story time varies anywhere from 10-17 minutes.

11:40ish – 11:45 AM: Sword Drill Time

- Encourage the kids to participate and play

11:45 - 12:10 PM: Craft Time

- Kids do the craft that relate to the Bible story or theme of the day.

12:10 PM: Dismissal

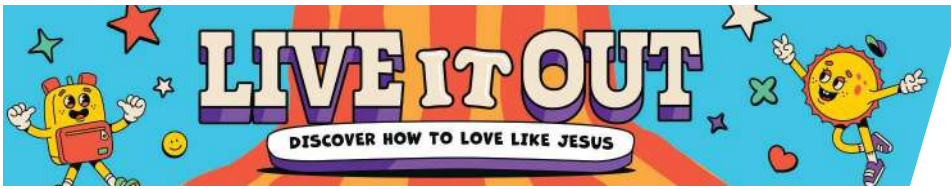

WEEK
THREE
JULY 2025

LARGE
GROUP
COLLIDE

Today's Bible Story: I'll Be There for You (Jesus Heals on the Sabbath) • Philippians 2:4

Today's Key Question: Who's looking out for you?

Today's Bottom Line: Look out for one another.

Monthly Memory Verse: As you deal with one another, you should think and act as Jesus did.

Philippians 2:5 (NirV)

Monthly Virtue: What God is doing in you to change the world around you.

Basic Truth: I should treat others the way I want to be treated.

LARGE GROUP:

Optional Video (Media Package): Countdown

Optional Video (Media Package): Theme

OPENER

HOST: "Good morning, happy campers! It's another great day together learning to love like Jesus! Let's get this day! All summer we're finding out what it means to live like Jesus. We can follow Jesus' example and see how He showed God's love and made everyone feel valuable and important. But it isn't just about knowing how to live. With God's help, we can actually live that way, every day. We can live it out! We'll be finding out how we can 'Live It Out'—in other words, how we can love like Jesus. That's definitely the best way to live!

Now let's stand and worship our amazing God together!"

WORSHIP

HOST: "Hi, friends! This is our time to lift our voices and praise God. Did you know that you can live your whole life for God? It's true. Everything we do and everything we say can be a way to worship. God can give us the strength to see each day as a gift, and a chance to show love to the people around us

VIDEO: "(Lyric Video)"

Now why don't we turn our eyes, ears and hearts towards the screen and watch this week's bible story together.

VIDEO: Bible Story W3

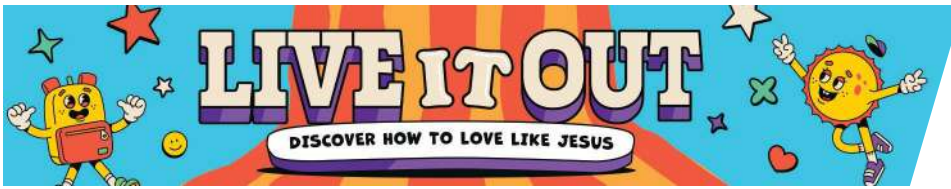

WEEK
THREE
JULY 2025

LARGE
GROUP
COLLIDE

AFTER BIBLE STORY

HOST: “Looking out for others was always at the center of Jesus’ life and work. He didn’t just notice others; He really saw them and their needs. Because of that, He was able to show love to people in the exact way they needed it. If we want to love like Jesus, it will mean taking our eyes off ourselves and first looking at Jesus so we can learn from Him.

“When we begin to take our eyes off ourselves and look at Jesus, He will also show us how to really see what others are experiencing, so we can look out for them. It may mean doing something that makes someone else look good in the end rather than making ourselves look good. It may mean sacrificing our time and energy to go out of our way to help someone else. But THAT is what it means to LIVE IT OUT and love like Jesus.

“You can ask God to take your focus off YOU and help you look out for what the people around you need. The more time and energy you spend looking out for others, the more God can work through you to change the world around you.”

HOST: “As you start your craft today, think about this:

SLIDE: Key Question

[Key Question] “Who’s looking out for you? Think about who you have in your life who is looking out for you—like a friend, coach, teacher, or parent. But then flip it and consider who YOU are looking out for. Who might God be asking you to look out for right now? If you’re not quite sure how you’d answer those questions, that’s totally fine. You’ll have a chance to talk all about that and more with at your table, but before you start your craft, let’s pray and ask God to help us see others the way God sees them.”

SLIDE: Theme Background

Host leads group in a prayer related to what they just heard. After prayer, Host encourages kids to play sword drill.

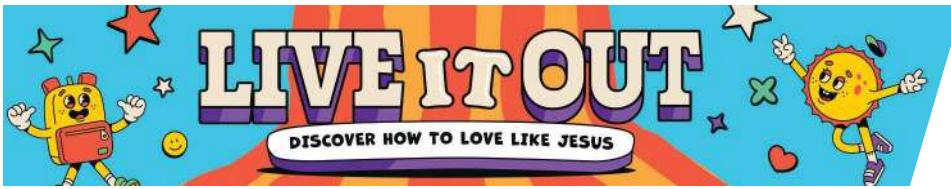

WEEK
THREE
JULY 2025

LARGE
GROUP
COLLIDE

SLIDE : SWORD DRILL

“Before we start out craft, we’re going to play a fun game called Sword Drill! The Bible is sometimes called the 'sword of the Spirit,' and in this game, we get to practice using it!

Here’s how we play:

- Everyone holds their Bible closed and straight up in the air.
- I will call out a Bible verse — like 'John 3:16.'
- When I say 'GO!', you’ll race to find that verse in your Bible.
- Once you find it, stand up and read it out loud.

“We’re going to look for three Bible verses today. For each verse, the first person to find it, stand up, and read it out loud will be the winner! Each winner gets to come up to the stage and choose a prize from the treasure box!

Let’s see who can find the verse the fastest — but remember, it’s not just about speed. It’s about learning how to find God’s Word and hide it in our hearts!

SLIDE : JULY WEEK 3 CRAFT

SLIDE: JULY COLLIDE CRAFT INSTRUCTIONS W3

JULY WEEK 3

COLLIDE INSTRUCTIONS

MAGNIFYING CLASS

1



THINGS YOU NEED

2

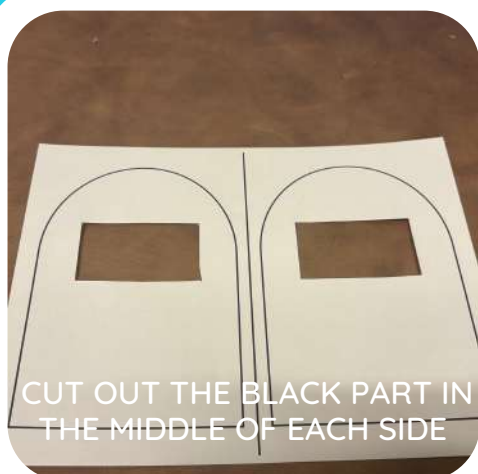

CUT OUT THE BLACK PART IN
THE MIDDLE OF EACH SIDE

3

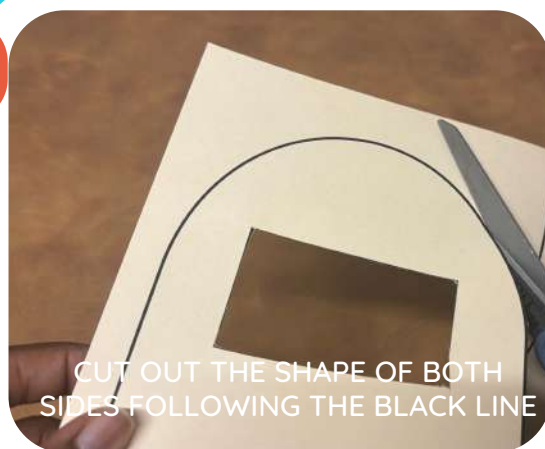

CUT OUT THE SHAPE OF BOTH
SIDES FOLLOWING THE BLACK LINE

4

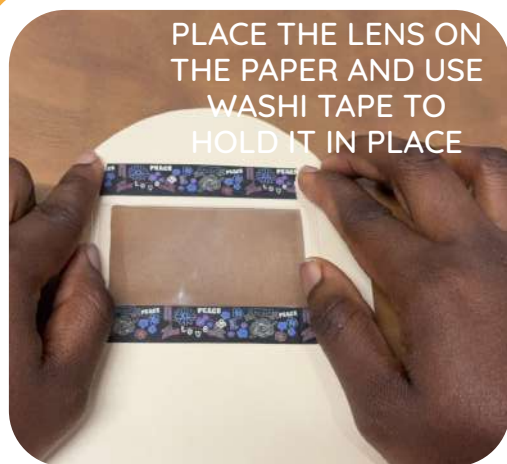

PLACE THE LENS ON
THE PAPER AND USE
WASHI TAPE TO
HOLD IT IN PLACE

5



APPLY GLUE ON ONE SIDE
OF THE FIRST PIECE

6



ATTACH ONE SIDE OF THE
PAPER TO THE SECOND PEECE

JULY WEEK 3

COLLIDE

INSTRUCTIONS

MAGNIFYING GLASS

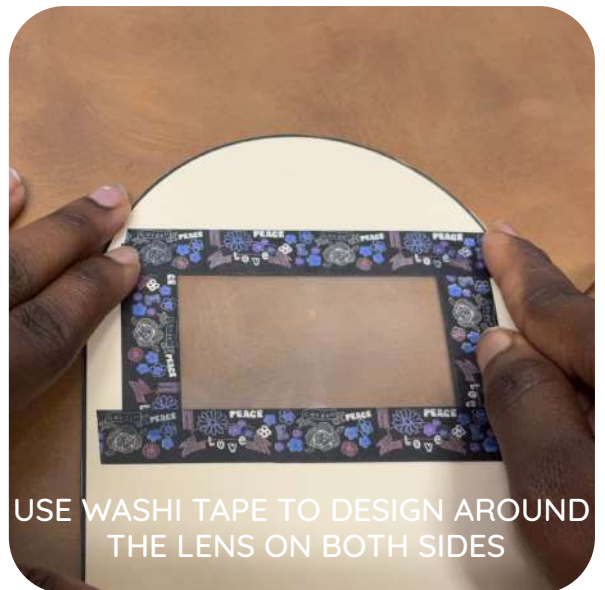

USE WASHI TAPE TO DESIGN AROUND THE LENS ON BOTH SIDES

8



APPLY GLUE ON THE BACK OF THE BOTTOM LINE TAG AND STICK ON THE PAPER

9

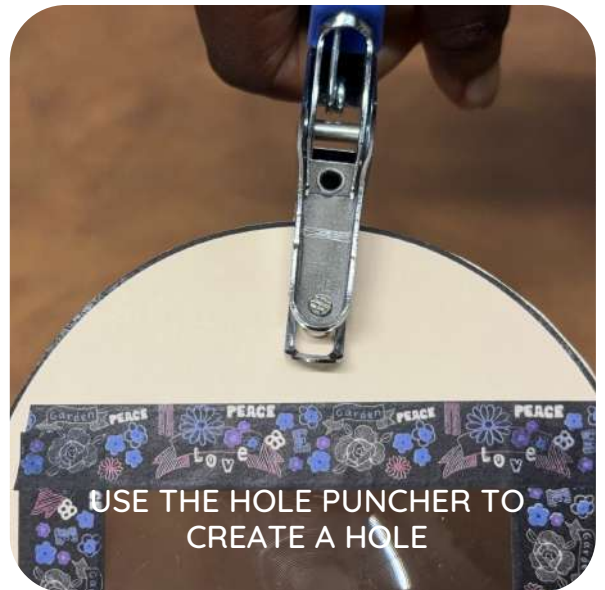

USE THE HOLE PUNCHER TO CREATE A HOLE

10



PUT THE PIPE CLEANER THROUGH THE HOLE AND TIE A KNOT

11



ALL DONE!