

169 PARKING SPACES
21 - PARKING LOT
148 - STREET PARKING

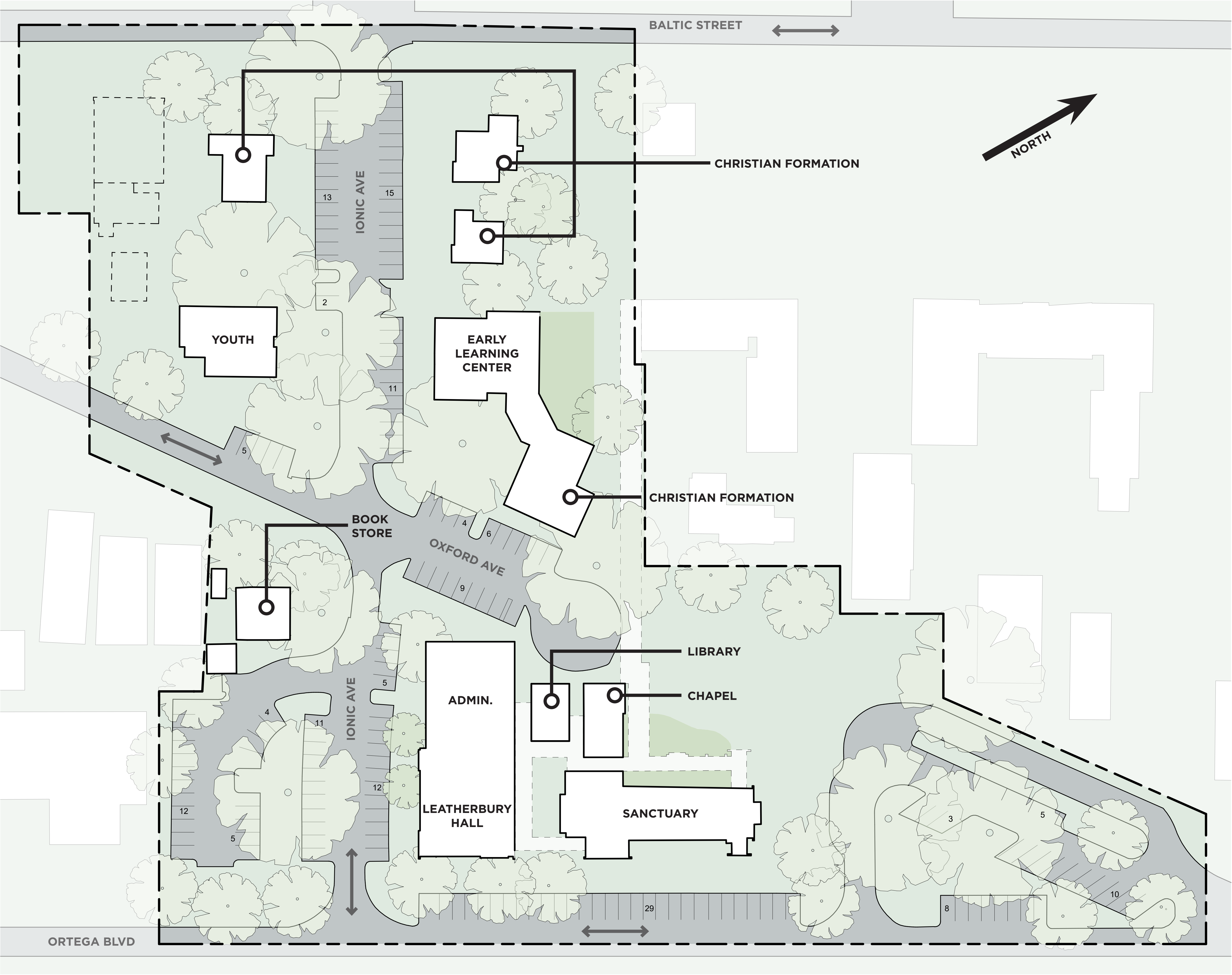

ST. MARK'S MASTERPLAN - EXISTING CONDITIONS

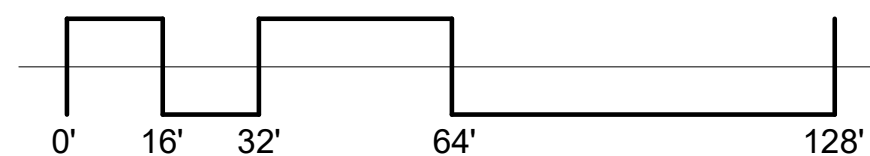

- SPIRITUAL LIFE CENTER
- SANCTUARY IMPROVEMENTS
- PARISH GATHERING
- CHRISTIAN FORMATION - ELC
- CHRISTIAN FORMATION - CLASSROOMS
- CHRISTIAN FORMATION - YOUTH
- ADMINISTRATIVE

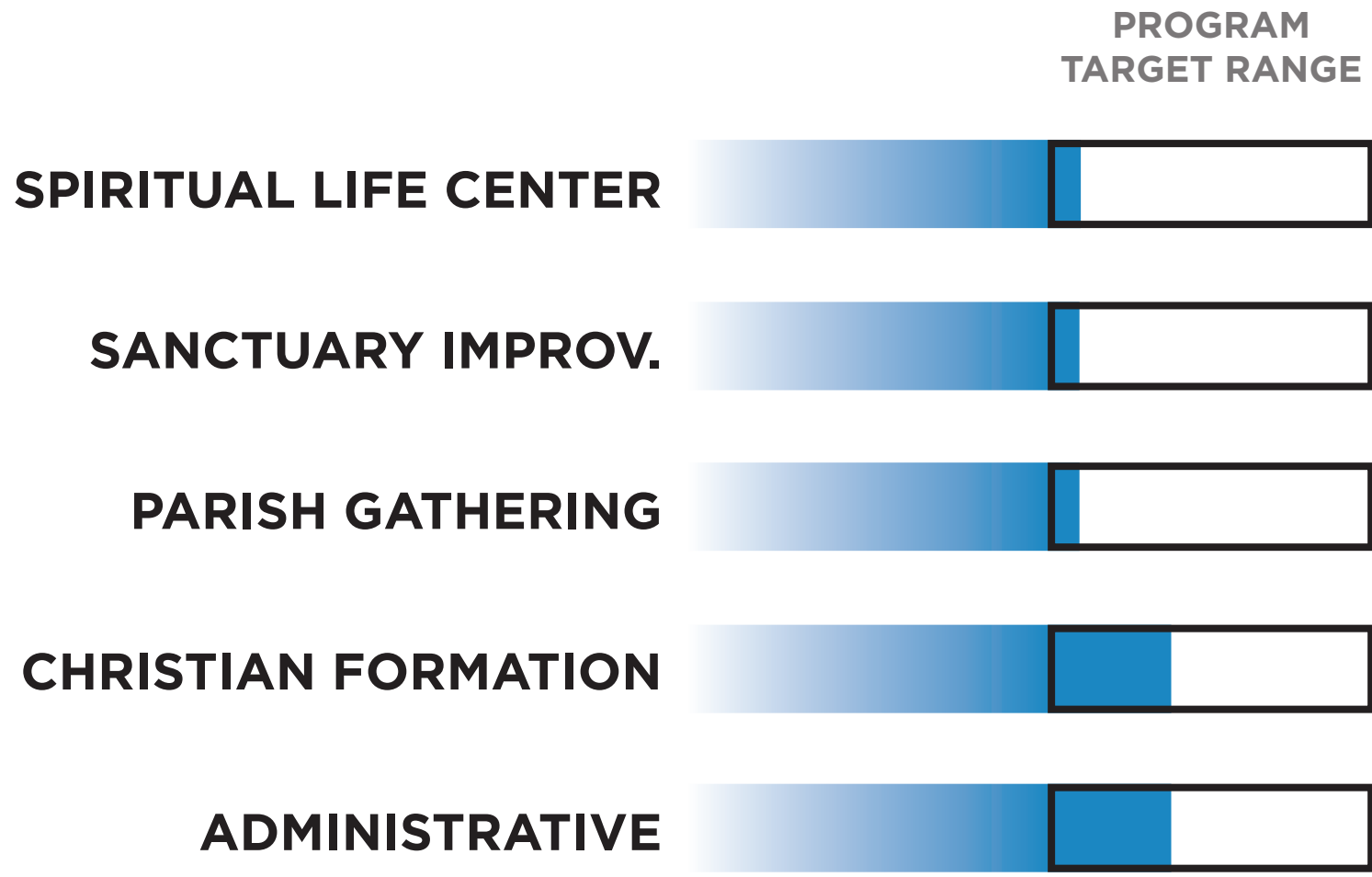

198 PARKING SPACES
104 - PARKING LOT
94 - STREET PARKING

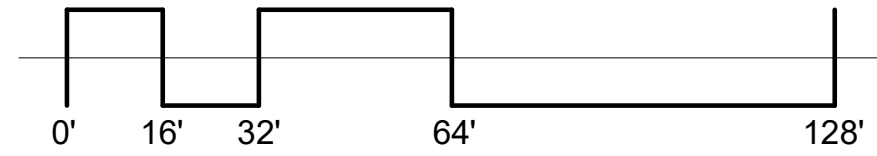

- SPIRITUAL LIFE CENTER
- SANCTUARY IMPROVEMENTS
- PARISH GATHERING
- CHRISTIAN FORMATION - ELC
- CHRISTIAN FORMATION - CLASSROOMS
- CHRISTIAN FORMATION - YOUTH
- ADMINISTRATIVE

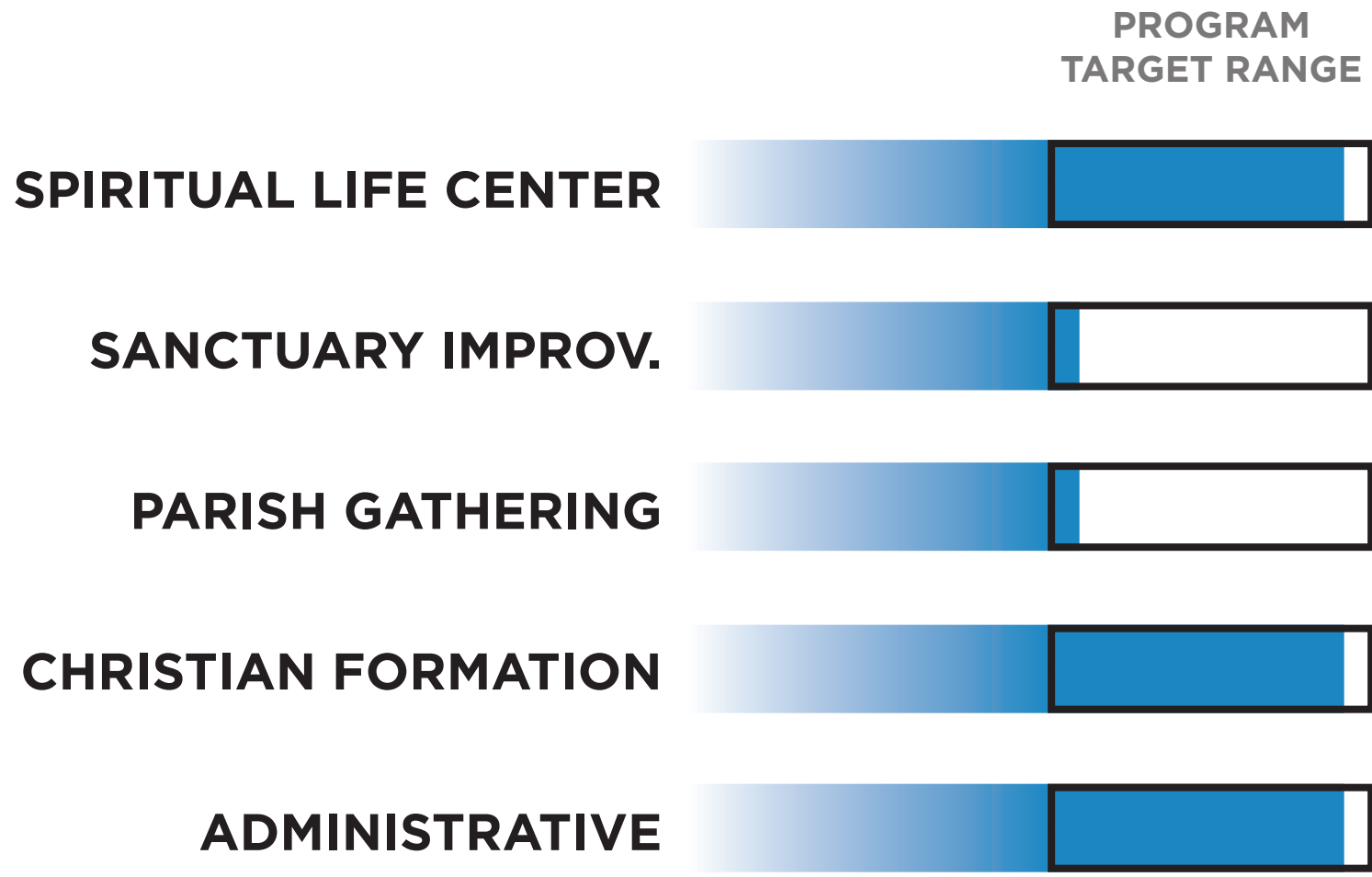

191 PARKING SPACES
100 - PARKING LOT
91 - STREET PARKING

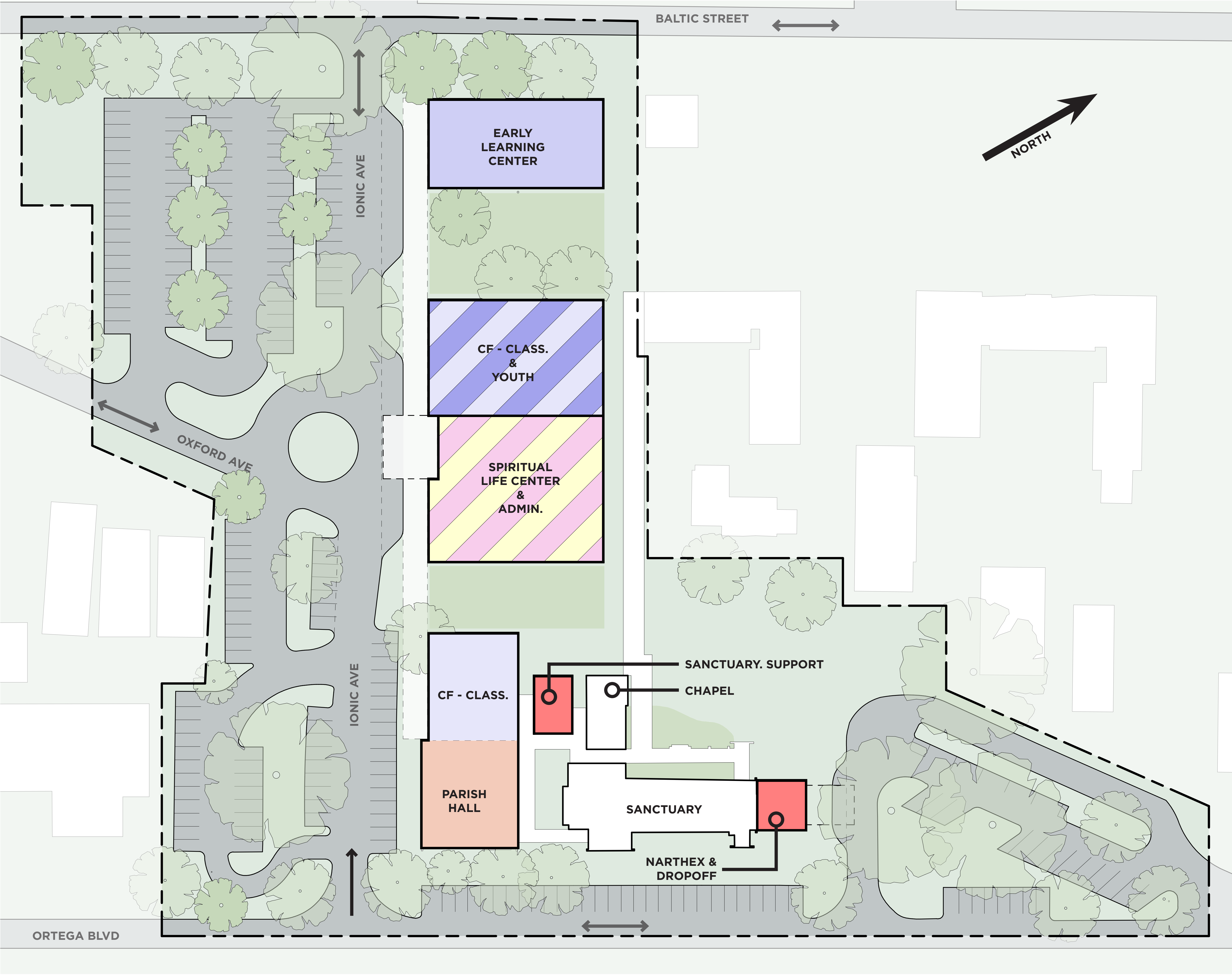
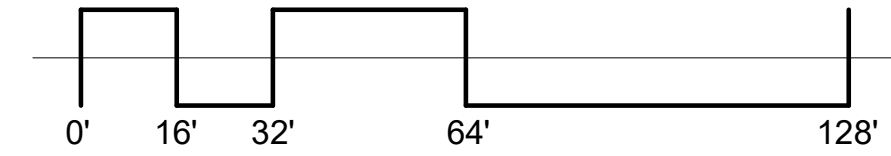

ST. MARK'S MASTERPLAN - CLOSE OXFORD



- SPIRITUAL LIFE CENTER
- SANCTUARY IMPROVEMENTS
- PARISH GATHERING
- CHRISTIAN FORMATION - ELC
- CHRISTIAN FORMATION - CLASSROOMS
- CHRISTIAN FORMATION - YOUTH
- ADMINISTRATIVE

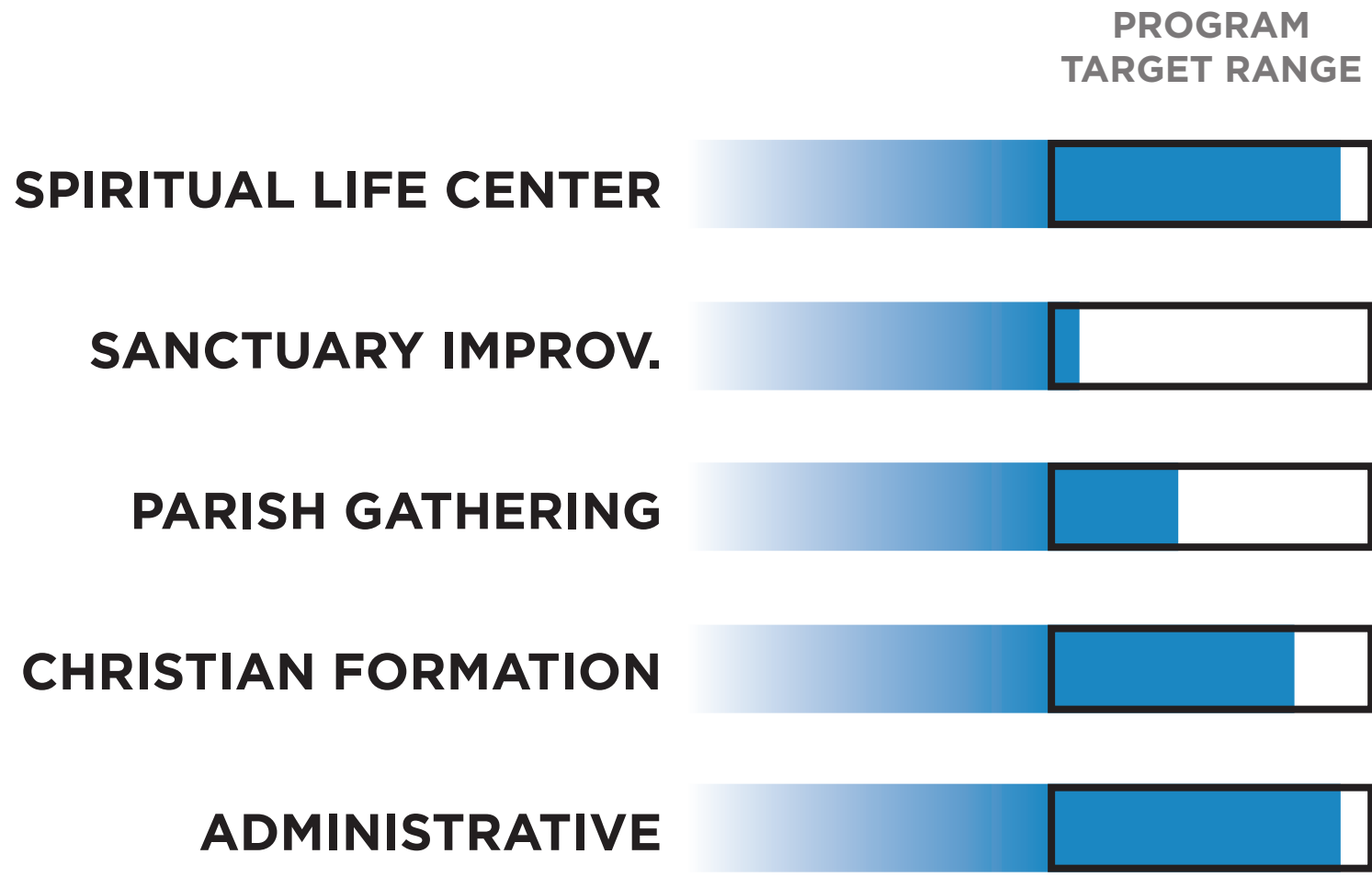

198 PARKING SPACES
 112 - PARKING LOT
 86 - STREET PARKING

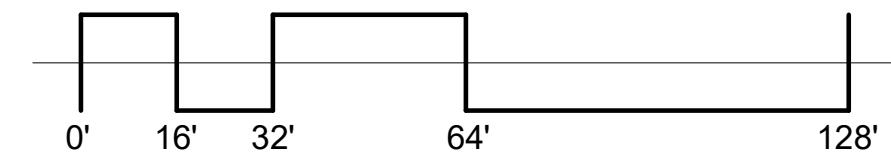

ST. MARK'S MASTERPLAN - CLOSE IONIC AND OXFORD



- SPIRITUAL LIFE CENTER
- SANCTUARY IMPROVEMENTS
- PARISH GATHERING
- CHRISTIAN FORMATION - ELC
- CHRISTIAN FORMATION - CLASSROOMS
- CHRISTIAN FORMATION - YOUTH
- ADMINISTRATIVE

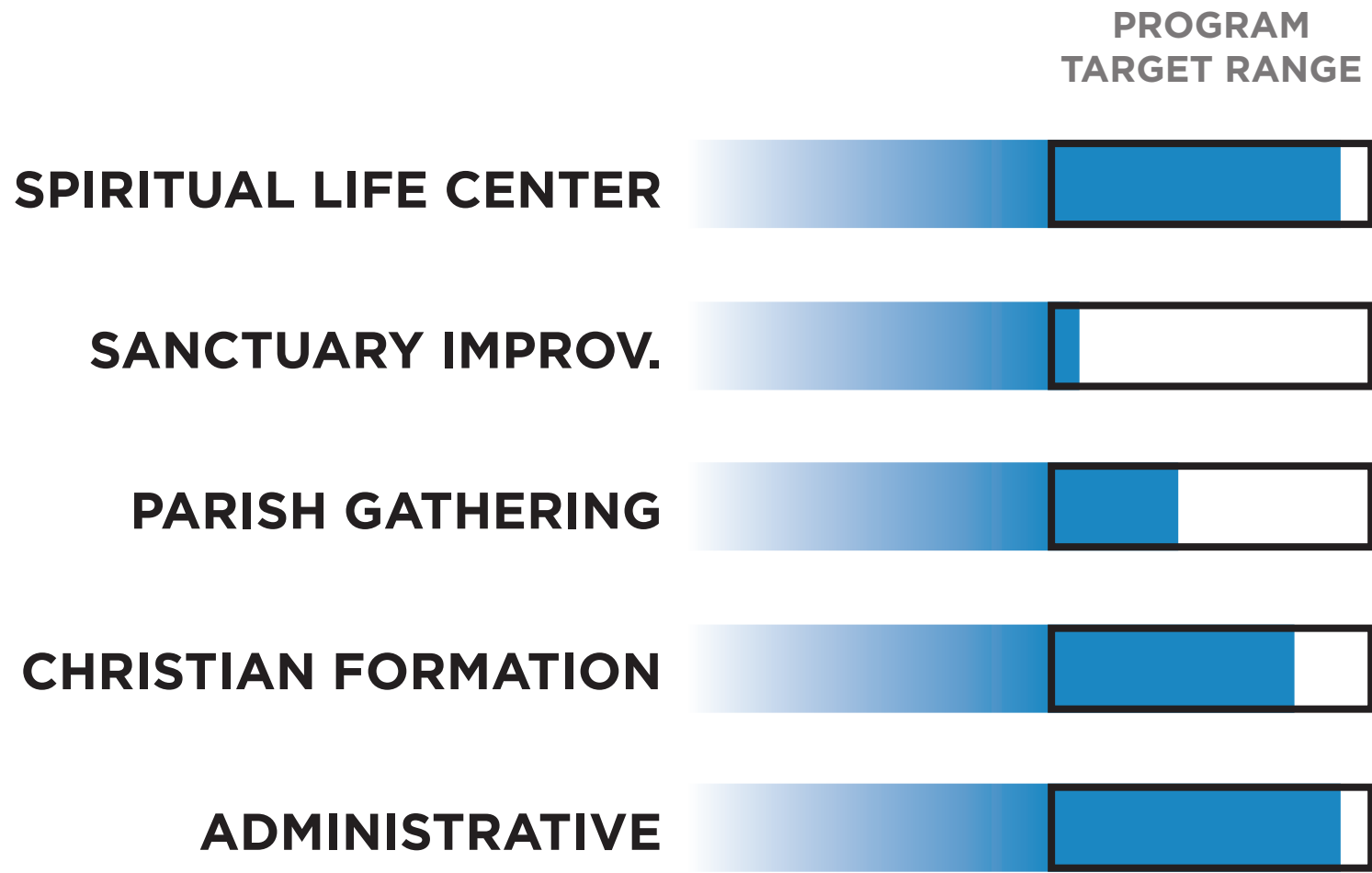

191 PARKING SPACES
109 - PARKING LOT
82 - STREET PARKING

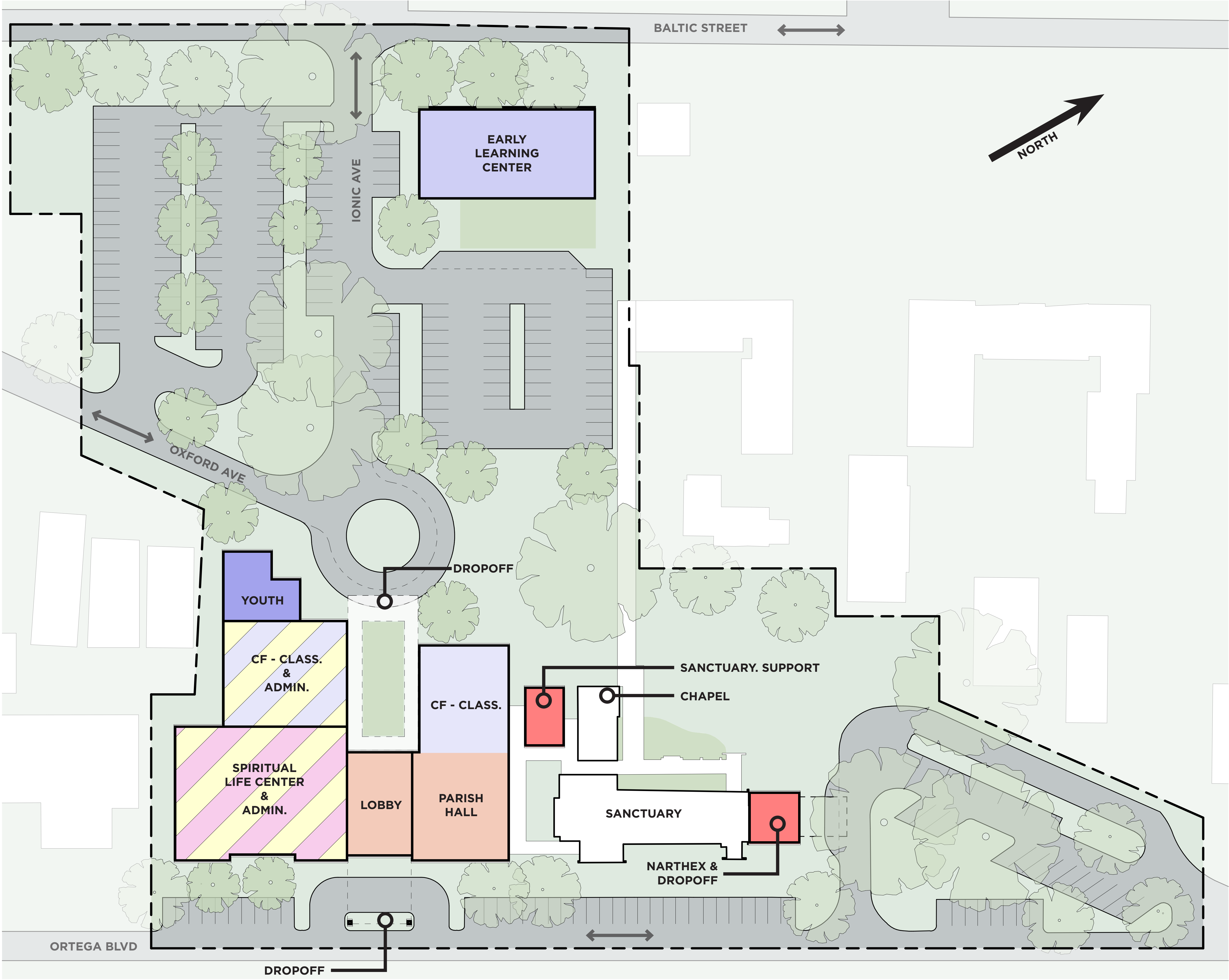
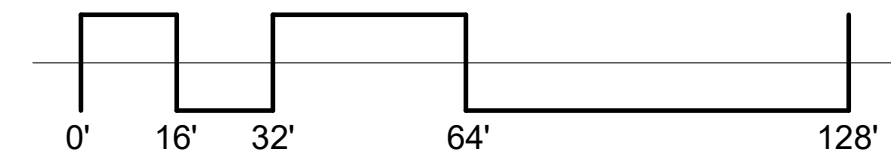

ST. MARK'S MASTERPLAN - CLOSE IONIC AND OXFORD - PHASE 2

