



SAM OLSHIN



MASON LEHMAN

CONCEPT PRESENTATION

**CAMPUS RENEWAL
26 FEB. 2025**

AOS
ARCHITECTS



MASTER PLAN BENEFITS

STRATEGIC VISION AND DIRECTION

- Aligns St. Mark's physical spaces with its mission, vision, and ministry goals.
- Provide a roadmap for changing needs over time.

CONGREGATIONAL GROWTH

- Envisions spaces that encourage participation.
- Enhances the beauty of the campus, creating a sense of pride and ownership.

EFFICIENT USE OF RESOURCES

- Avoids uncoordinated or short-sighted projects.
- Facilitates responsible use of resources to reassure the parish.

RISK MITIGATION

- Plans for zoning approvals and code compliance.
- Reduces delays and unexpected costs as the time of implementation.

ENHANCED FUNDRAISING POTENTIAL

- Inspires a well-articulated vision for the future.
- Identifies projects in manageable phases that can be implemented when appropriate.

MASTER PLAN PROCESS

Assessment



- Evaluate
- Survey
- Archival Review
- Set Basepoint

4-6 weeks

Programming

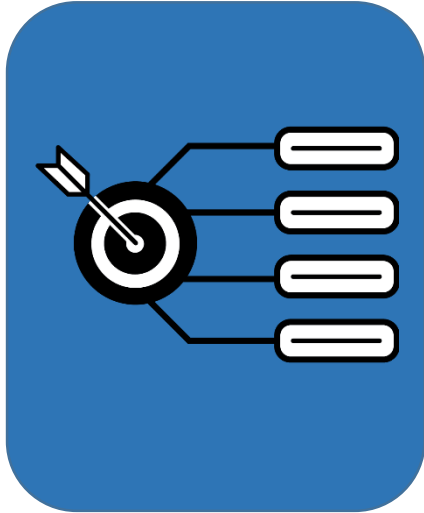

- Listen
- Learn
- Set Goals
- Establish Vision

4-6 weeks

Concept Design

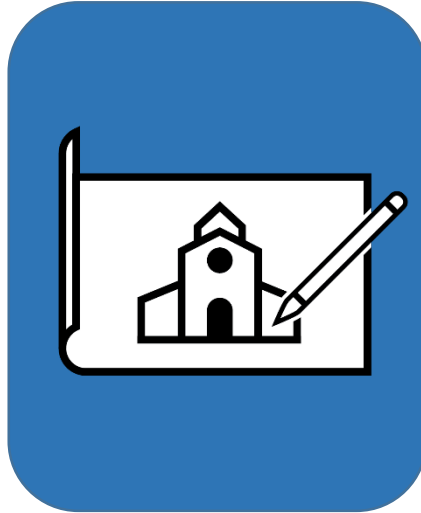

- Envision
- Visualize
- Weigh Options
- Set Aesthetics

2-3 months

Fundraising

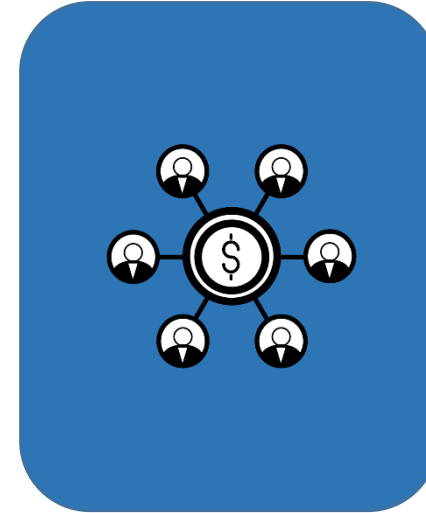

- Engage
- Establish Goals
- Connect
- Begin Campaign

6-12 months

Implementation

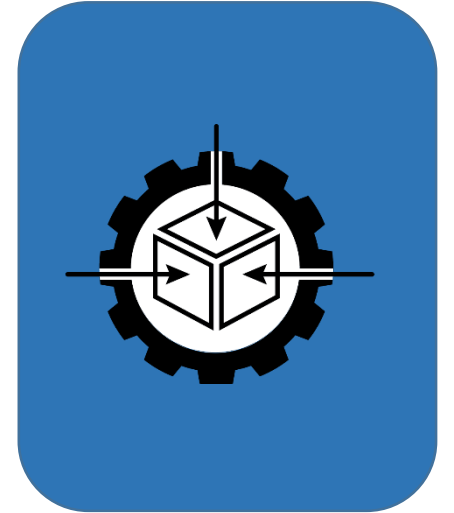

- Design
- Document
- Construct
- Realize Vision

2-3 years

PROGRAMMING

Programming via Insight Teams

Existing
Sanctuary

Parish
Gathering
Space

Admin. and
Meeting

Spiritual Life
Center

Christian
Formation

Campus
Improvements

Collect Input via Questionnaire

Parish Questionnaire

PROGRAM SUMMARY

Existing
Sanctuary

Sanctuary
4,500sf
Support
1,100sf

Parish
Gathering
Space

Leatherbury
4,500sf
Support
900sf

Admin. and
Meeting

Admin.
8,000sf

Spiritual Life
Center

The River
Sanctuary

Christian
Formation

Classrooms
8,800sf
Youth
3,000sf
ELC
5,000sf

Masterplan SF
2,000sf
to
2,800sf

Masterplan SF
7,500sf
to
9,500sf

Masterplan SF
9,000sf
to
11,000sf

Masterplan SF
9,000sf
to
12,000sf

Masterplan SF
29,000sf
to
32,000sf

PROGRAM SUMMARY

Existing
Sanctuary

Parish
Gathering
Space

Admin. and
Meeting

Spiritual Life
Center

Christian
Formation

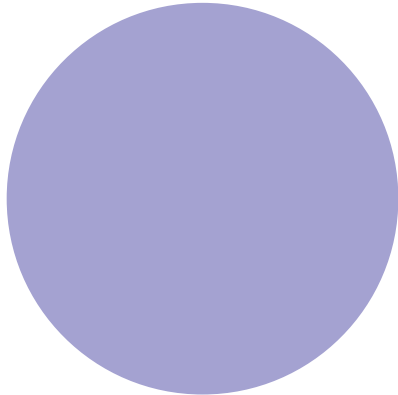
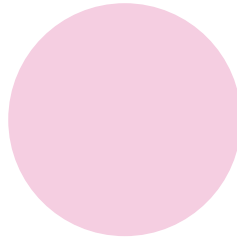
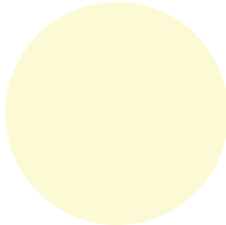
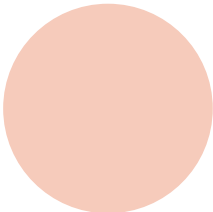

Masterplan SF
2,000sf
to
2,800sf

Masterplan SF
7,500sf
to
9,500sf

Masterplan SF
9,000sf
to
11,000sf

Masterplan SF
9,000sf
to
12,000sf

Masterplan SF
29,000sf
to
32,000sf



169 PARKING SPACES
21 - PARKING LOT
148 - STREET PARKING



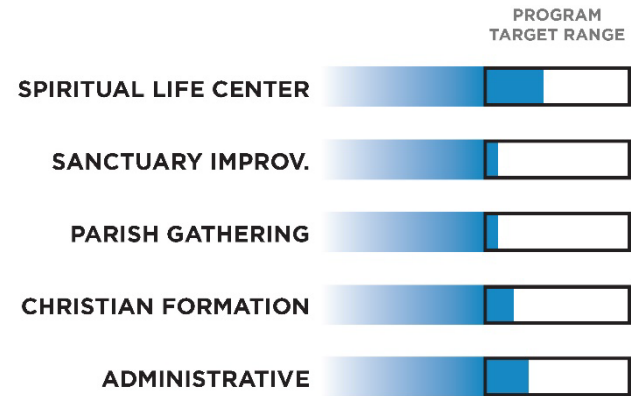
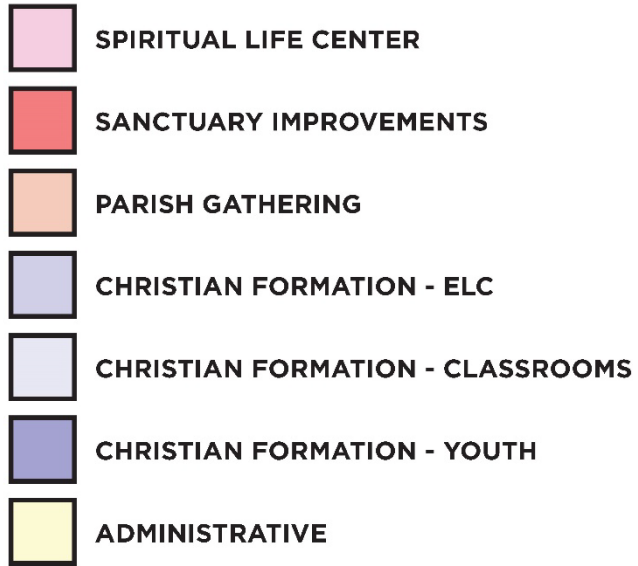

215 PARKING SPACES
 86 - PARKING LOT
 129 - STREET PARKING

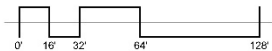

PROS

- Preserves circulation routes
- Future potential for growth or development along Baltic
- Covered walkway link structures and slows traffic

CONS

- Ionic separates campus
- Parking lot is remote
- Safety concerns crossing Ionic
- Property setback concerns

215 PARKING SPACES
86 - PARKING LOT
129 - STREET PARKING



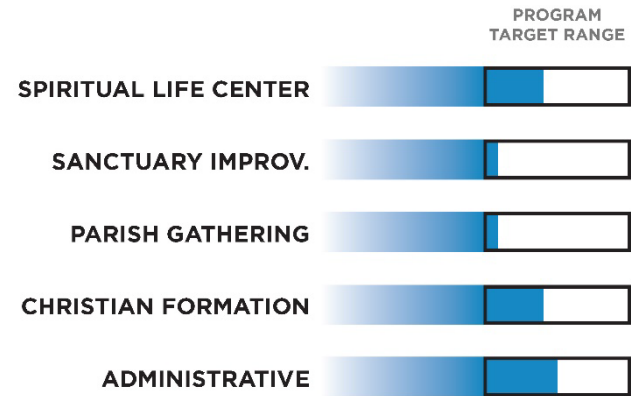
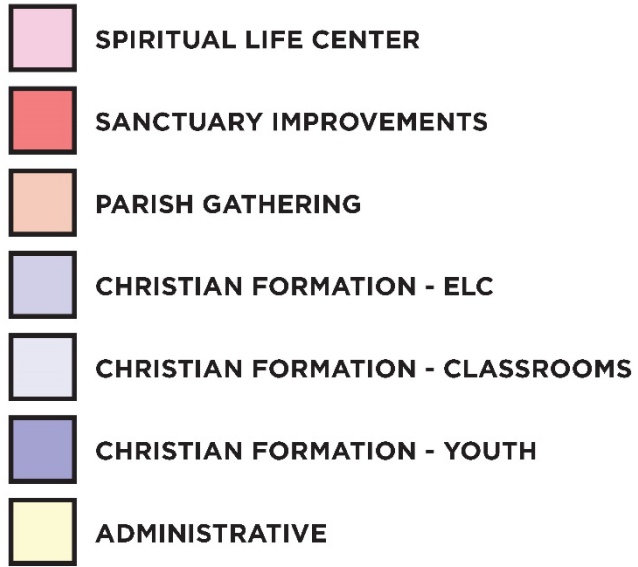

200 PARKING SPACES
86 - PARKING LOT
114 - STREET PARKING

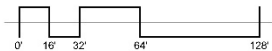

ST. MARK'S MASTERPLAN - CLOSE OXFORD AND PARKING LOT



PROS

- Minimal existing building demolition
- Future potential for growth or development along Baltic
- Covered walkway link structures and slows traffic

CONS

- Ionic separates campus
- Safety concerns crossing Ionic
- Interrupts Oxford view corridor
- Property setback concerns

200 PARKING SPACES
86 - PARKING LOT
114 - STREET PARKING



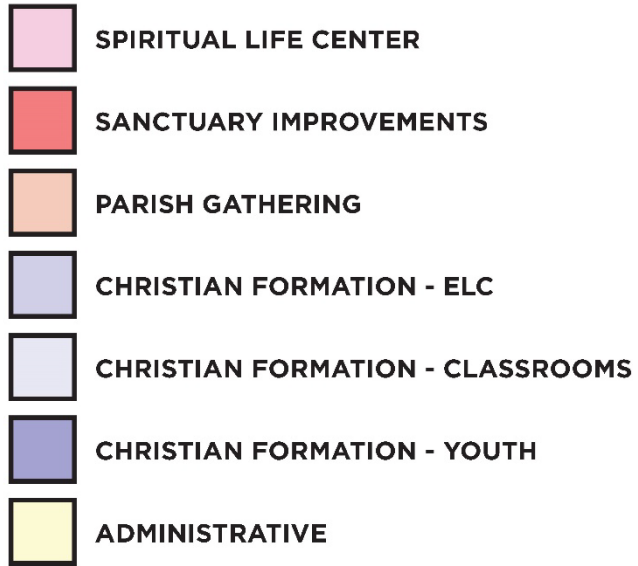

228 PARKING SPACES
125 - PARKING LOT
103 - STREET PARKING

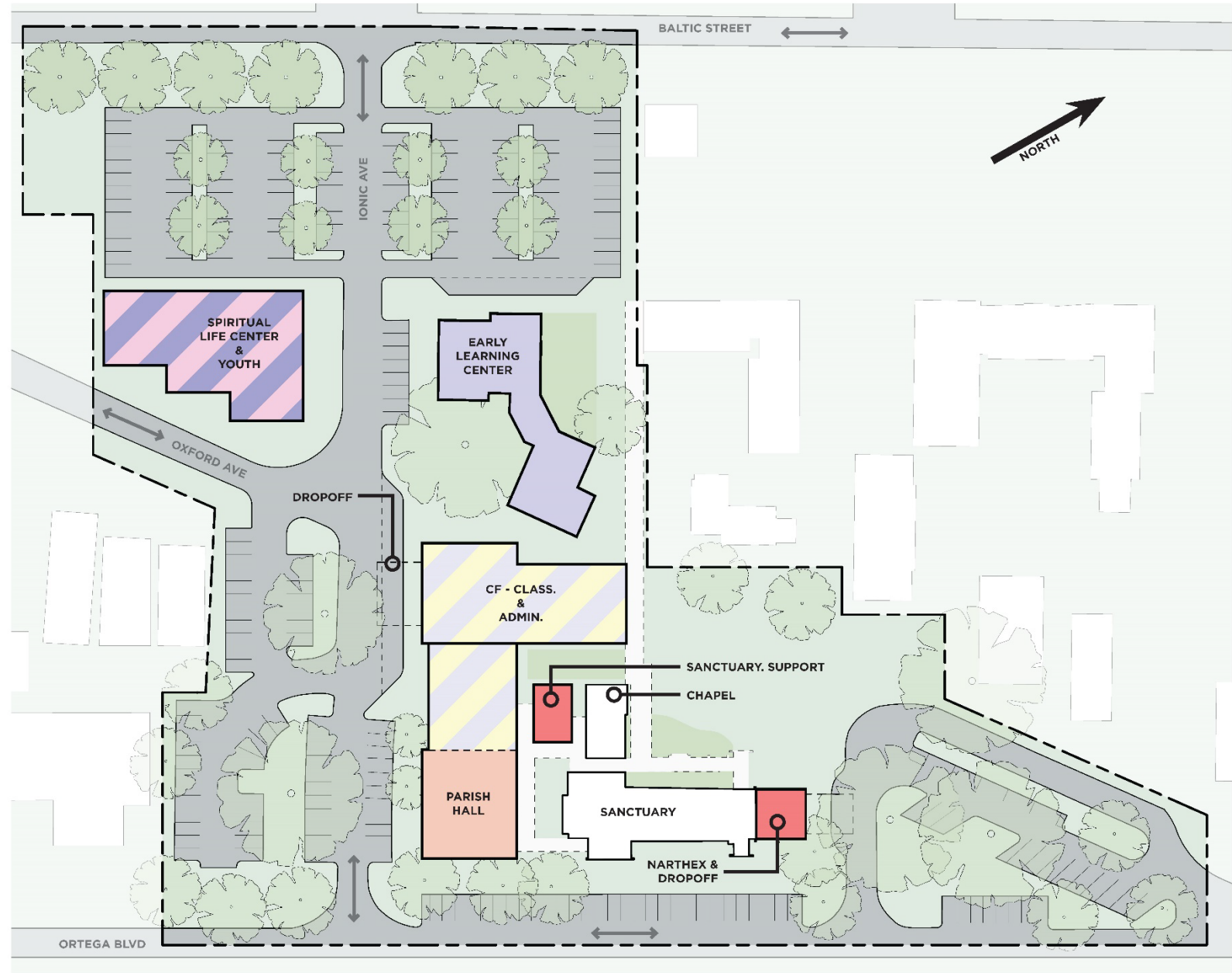
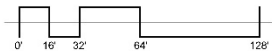

PROS

- Existing parking lot remains close to buildings
- Improves parking capacity
- Drop-off with dedicated lay-by lane

CONS

- SLC is remote from rest of church
- Safety concerns crossing Ionic
- Interrupts Oxford view corridor

228 PARKING SPACES
125 - PARKING LOT
103 - STREET PARKING

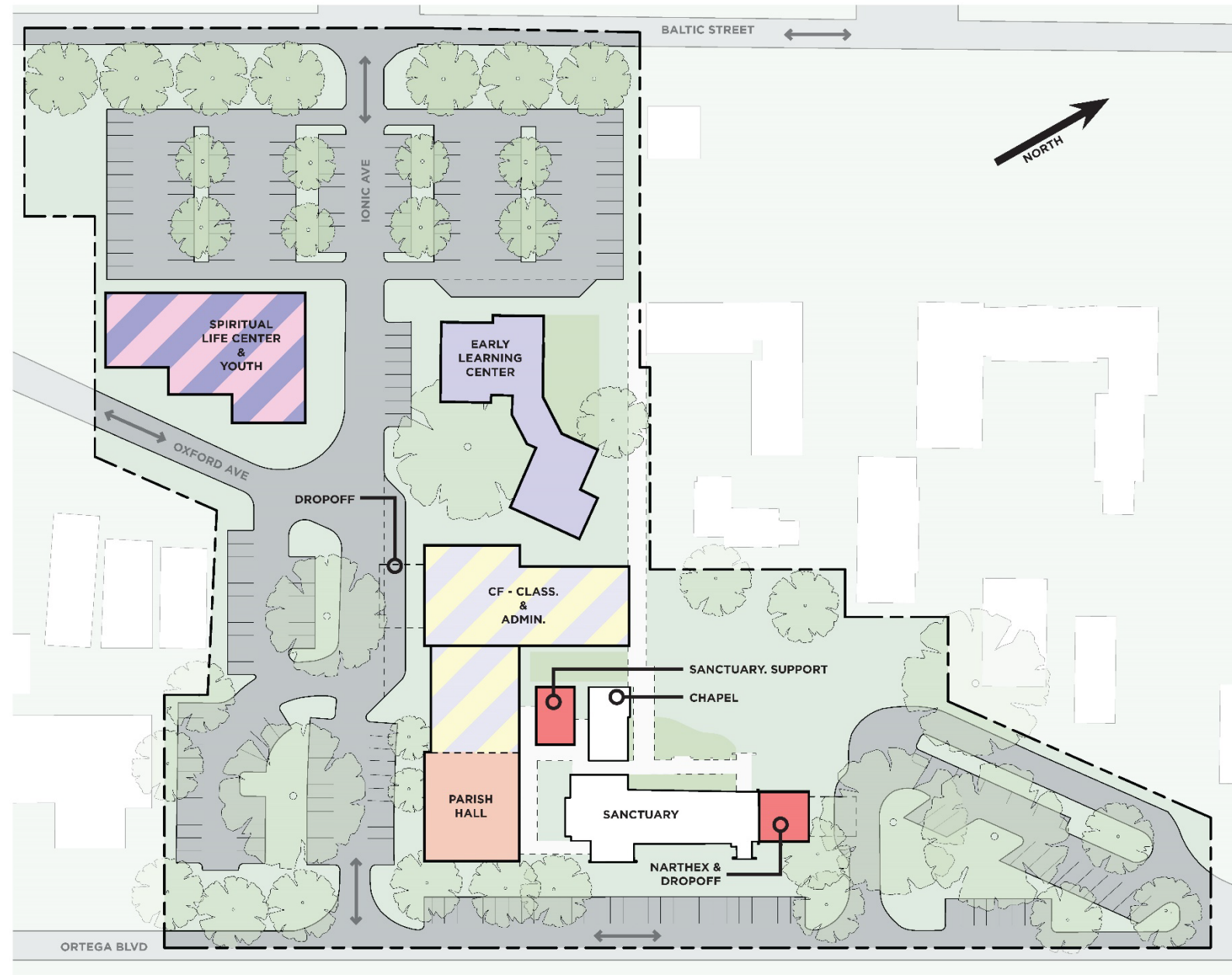

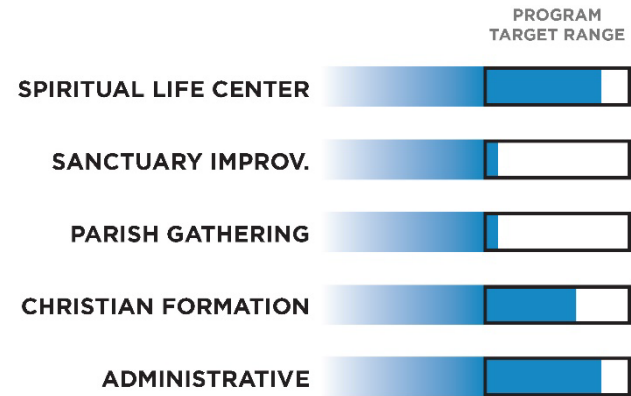
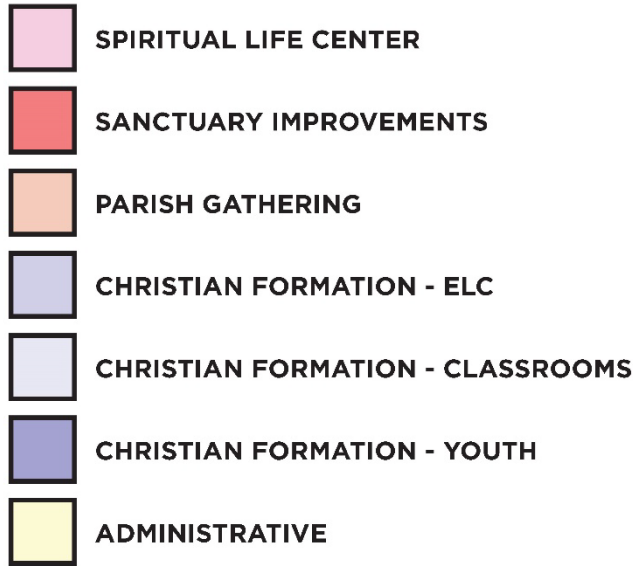

179 PARKING SPACES
86 - PARKING LOT
93 - STREET PARKING

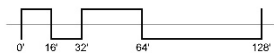

PROS

- Connects major spaces without street crossings
- Multiple drop-off locations
- Consolidates and unifies campus
- Maintains Oxford view corridor

CONS

- Street closure requires approval
- May require utility relocation at Ionic
- Most parking is remote

179 PARKING SPACES
86 - PARKING LOT
93 - STREET PARKING

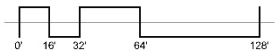

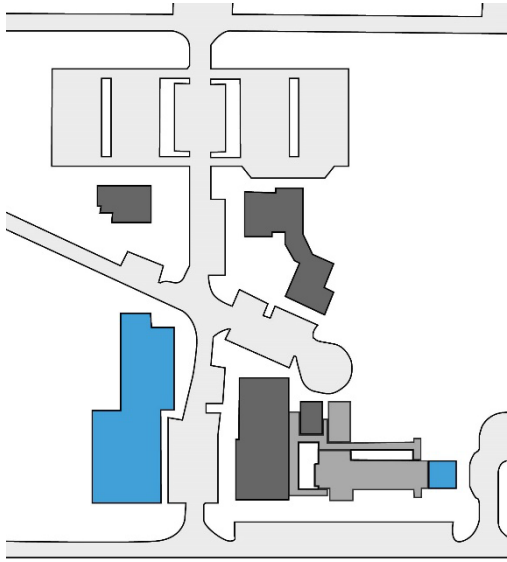

A

No Road Closures

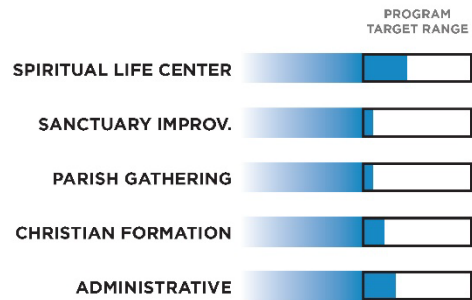

215 PARKING SPACES
86 - PARKING LOT
129 - STREET PARKING

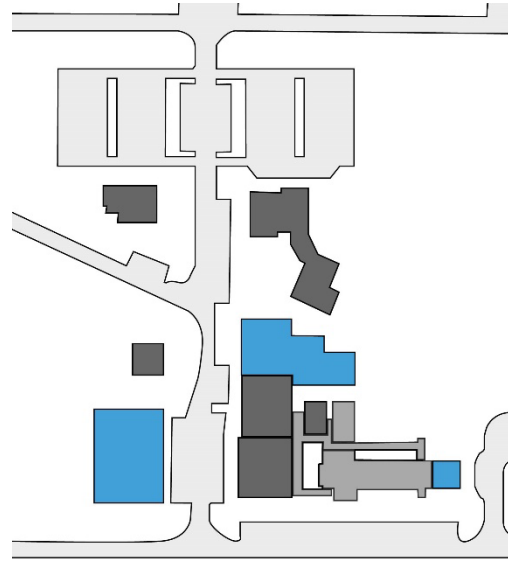

B

Close Oxford and Parking Lot

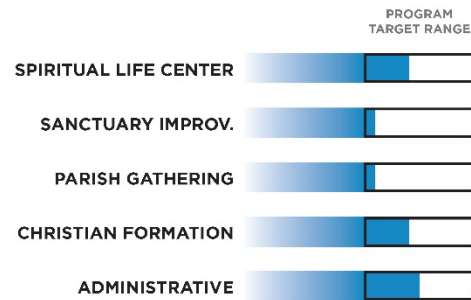

200 PARKING SPACES
86 - PARKING LOT
114 - STREET PARKING

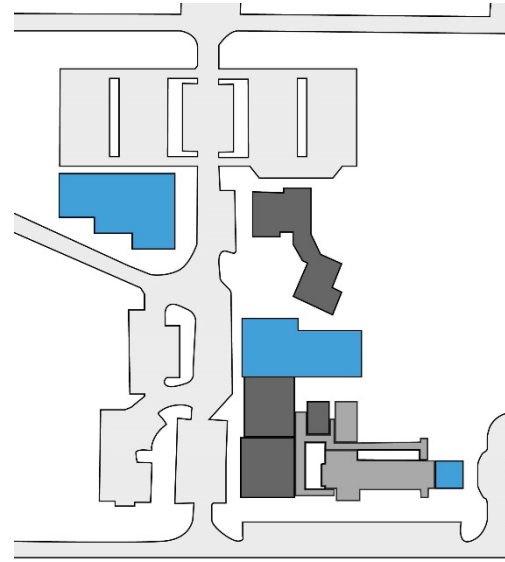

C

Close Oxford

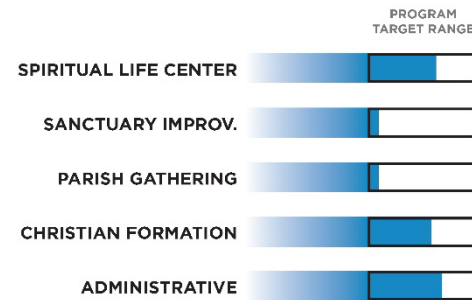

228 PARKING SPACES
125 - PARKING LOT
103 - STREET PARKING

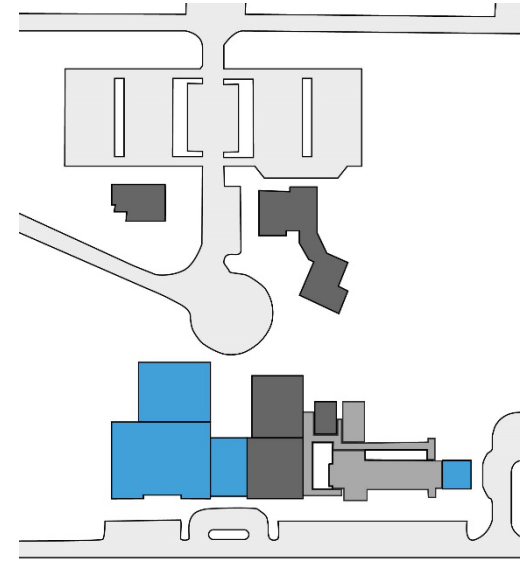

D

Close Oxford and Ionic

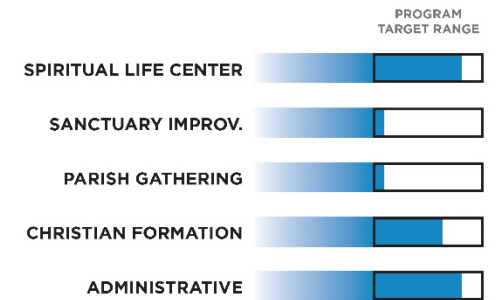

179 PARKING SPACES
86 - PARKING LOT
93 - STREET PARKING