

MEET OUR STAFF



DARRELL TOMASEK, D.MIN.
Senior Pastor
dtomasek@nbcvictoria.org



DEAN MEADE, D.MIN.
Discipleship Pastor
deanmeade@nbcvictoria.org



STEPHEN SUMMERS
Worship Pastor
stephensummers@nbcvictoria.org



CODY MOORE
Student Pastor
codymoore@nbcvictoria.org



DAVE BENEFIELD
Children's Pastor
davebenefield@nbcvictoria.org

SHARE THE JOURNEY

GET INVOLVED

Sunday, December 25
10:30a Worship Service

Monday, December 26
Office Closed

Tuesday, December 27
6:00p Celebrate Recovery

Wednesday, December 28
No Evening Activities

CHURCH SECURITY: For security purposes, the doors to the church buildings will be open 30 minutes before a service or event. This includes Sunday mornings and Sunday evenings.

(Please note that the calendar was correct at the time of printing. Changes may have occurred after printing that would cause the calendar to be inaccurate.)

COUNT OUR BLESSINGS

Budget Gifts Last Week	\$21,299.71
Given Year to Date	\$213,682.51
Need Year to Date	\$220,801.00

STOPS ON THE JOURNEY

Go to nbcvictoria.org/wg for a digital copy of this Worship Guide



HOLIDAY SCHEDULE

There will be no Wednesday evening activities on December 28. The office will be closed December 26 and January 2.



JANUARY WOMEN'S NIGHT

Women's Night in January will be a bit different. There will still be Bible study and snacks, but we are having a paint night at the end. Sign up on the events page of our website if you would like to participate in the paint portion of the evening. The cost is \$49. Deadline to register is December 30.



UPWARD SOCCER REGISTRATION OPEN

Upward Soccer registration is open for \$130. Registration will close when teams are full, so register early! Practices will start the week of March 6 and the games will be on Saturdays March 25 to April 29.

DATE NIGHT

Date Night is this Friday, January 6. Childcare is offered at the church from 6:00 - 10:00pm for \$10 per child. Childcare is free if you are attending a Northside fellowship. Please register at nbcvictoria.org on the Events Page by Wednesday, January 4.



LOTTIE MOON

The Lottie Moon Offering for International Missions runs through December 30. All money collected goes directly for international missions. Northside's goal is \$22,000 and \$18,995.00 has been given to date. Please designate your gift as "Lottie Moon" when you give in person and online at nbcvictoria.org.

CONTRIBUTIONS

In order to get contribution credit for 2022, your cash or check donations must be in the church office by December 30. If submitting a donation by mail, it needs to be postmarked by December 31. Online donations must be submitted by December 31.

NEW YEAR GROUPLIFE KICKOFF

On January 1, during the 9:30 AM Bible Study time, we will all meet together in the Worship Center to preview the upcoming groups for the semester.



RAD WEEKEND HOST HOMES

RAD Weekend is January 27-29, 2023. If you would be interested in being a host home, co-host, or helping that weekend contact Cody at 361-578-1568 or codymoore@nbcvictoria.org.

PRE-TEEN LOCK-IN: KIDS 3RD - 5TH GRADE

You won't want to miss the Pre-Teen Lock-In on January 6-7, 2023. The cost is \$20 and you can register now on the events page of our website.

northside
BAPTIST CHURCH

December 25, 2022

MERRY
AND
BRIGHT

CELEBRATING THE GIFT OF SALVATION



Worship Sundays at 10:45am

MULTI-GEN MULTI-ETHNIC
journeying ^together

northside
BAPTIST CHURCH

4100 North Laurent | Victoria, Texas 77901 | 361.578.1568
www.nbcvictoria.org

THOUGHTS ON THE JOURNEY

Can you imagine what that first Christmas must have been like for those who truly understood what was taking place? For hundreds of years, they had awaited the

“*Not only does Jesus say He is the light of the world, He also says that He is the light of life. It is in Jesus that we find life.*”

right over this claim without giving any real thought to its weight. But, if we think a little deeper, we will realize that what Jesus is saying is incredibly powerful.

Jesus makes His claim to being the light of the world while teaching at the Temple in the Court of the Women. In this court, there sits a very large Menorah that was lit during the Festival of Tabernacles. This flame was to remind the people of the pillar of fire that guided them while they were in the wilderness. Jesus’ claim was intended to connect himself to the pillar of fire in the wilderness and ultimately a claim to deity.

Now, as we walk this out a little further, we will give thought to the fact that the pillar of fire in the wilderness provided both direction and protection. It was in the dark hours that Israel needed these things. Add to that the fact that Jesus was born after 400 years of silence from God, and we see the connection. Out of a dark hour, the light of the world appears. Jesus provides the very same direction and protection that the pillar of fire in the wilderness did.

Not only does Jesus say He is the light of the world, He also says that He is the light of life. It is in Jesus that we find life. So, on that first Christmas, what came to us in the person of Jesus was so much more than a baby lying in a manger. Jesus gives life, direction, and protection. Let us celebrate this gift by surrendering to Him.

Honored to be your pastor,

DARRELL

TODAY’S WORSHIP

Joy to the World (Joyful Joyful)
(Watts/Handel/Dyke/Beethoven.Hodges.Wickham)

The First Noel
(Traditional English Carol)

Oh Holy Night
(Shipman/Wright)

Advent Reading- Christ

Away in the Manger
(Luther/ McFarlang/Murray)

MESSAGE
Out of the Darkness
John 8:12
DARRELL TOMASEK

Silent Night
(Young/ Gruber)

CCLI #2234

THERE ARE WOODEN BOXES NEXT TO THE WELCOME CENTER FOR YOUR TITHES.

SERMON NOTES



Out of the Darkness *John 8:12*

Notes:

WELCOME TO NORTHSIDE

UP IN OUT
journey ^ together

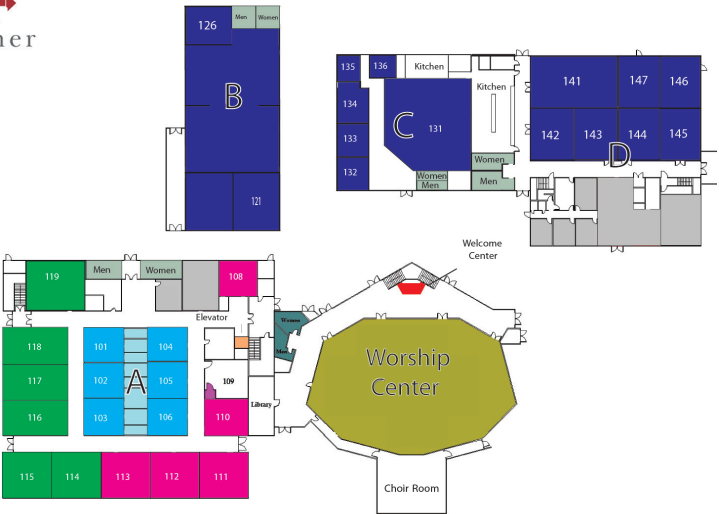

LISTEN ONLINE
Sunday Sermons are
on our website:
nbcvictoria.org



Connect @ Northside

Visit our website @ nbcvictoria.org for:

- Up-to-date Northside happenings
- Online event registrations
- Facebook
- Newsletter

Connect with YouVersion®

1. Open *You Version Bible* app.
2. Click more.
3. Go to Events and find Northside.

To get wi-fi in the Worship Center, choose the *northside mar* network. The password is *john 316*.