

MEET OUR STAFF



DARRELL TOMASEK, D.MIN.
Senior Pastor
dtomasek@nbcvictoria.org



DEAN MEADE, D.MIN.
Discipleship Pastor
deanmeade@nbcvictoria.org



STEPHEN SUMMERS
Worship Pastor
stephensummers@nbcvictoria.org



CODY MOORE
Student Pastor
codymoore@nbcvictoria.org



DAVE BENEFIELD
Children's Pastor
davebenefield@nbcvictoria.org

SHARE THE JOURNEY

GET INVOLVED

Sunday, July 9
9:30a Bible Study
10:45a Worship Service
10:45a Kid's Church
5:00p Sunday Evening Worship
5:00p Ecclesia
5:00p Student Huddle
5:00p Kid's Bible Study

Tuesday, July 11
6:00p Celebrate Recovery
6:30p Circle of Hope Bible Study

Wednesday, July 12
6:00p Connect
6:00p Student Midweek
6:00p Extreme Kids Live

CHURCH SECURITY: For security purposes, the doors to the church buildings will be open 30 minutes before a service or event. This includes Sunday mornings and Sunday evenings.

(Please note that the calendar was correct at the time of printing. Changes may have occurred after printing that would cause the calendar to be inaccurate.)

COUNT OUR BLESSINGS

Budget Gifts Last Week	\$33,462.54
Given Year to Date	\$1,021,661.54
Need Year to Date	\$1,104,005.00

STOPS ON THE JOURNEY

Go to nbcvictoria.org/wg for a digital copy of this Worship Guide



PRAY VALLEY MISSION TRIP
This week our mission team will be heading out to minister in the Valley. We will be leading a construction project, life skills classes, sports camp, and evening outreach movie nights. Please be in prayer for our team.

As a church, we will need to provide \$30,000 to fund the projects. If you would like to contribute, please mark your gift "Valley Mission Trip".



OPERATION CHRISTMAS CHILD
We are beginning to collect items for Operation Christmas Child. We will collect bar soap and washcloths for OCC in July. Please drop off your items at the church office.

STCH iCARE CONFERENCE
STCH is hosting the iCARE conference on August 1 from 8:00am- 5:00pm. CEU credits will be given for participating. It is \$30 per person with breakfast and lunch included. Topics include: Healthy boundaries, grief, joy through trials, victim to survivor, suicidality in teens, helping teens, anxiety, and more. To register go to www.stchm.org/icare-victoria. For questions call STCH at 361-575-5151.

NORTHSIDE SCHOOL REGISTRATION
Registration for the 2023-2024 school year is open! Our school is for 2 year olds through fifth grade and offers extended care hours until 5:30pm. We have certified teachers in Kinder - 5th grade, small classes, and a Christian atmosphere. Call 578-5601 or check out the website, nbsvictoria.org, for more information.



STARK COLLEGE & SEMINARY
Today there is a representative from Stark in the worship center lobby. The class held at Northside this fall will be Intro to Church History on Mondays from 7:00-9:45pm. If you are interested in this class or taking others from Stark stop by and talk to the representative. Also, check out www.stark.edu for more information.

LET US KNOW
If you or a loved one are in the hospital or need a visit, let us know. We can't know unless someone tells us.

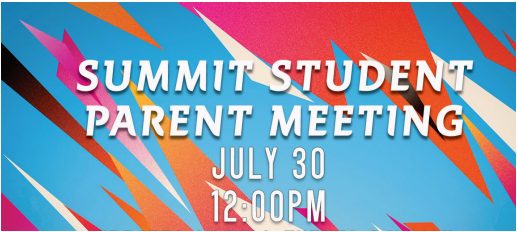

SUMMIT STUDENT PARENT MEETING
July 30, immediately following the worship service, we will have a Summit Student Parent meeting. We will discuss events and vision for this fall. Lunch will be provided. Please register at nbcvictoria.org on the Events Page to submit a head count for the meal.

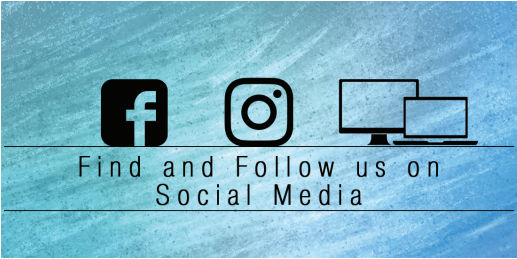

NORTHSIDE SOCIAL MEDIA
Follow our Facebook and Instagram page to stay up to date on all the events happening at Northside. Facebook- www.facebook.com/nbcvictoria Instagram- [@nbcvictoria](https://www.instagram.com/nbcvictoria) Website- www.nbcvictoria.org



July 9, 2023



THOUGHTS ON THE JOURNEY

When I pastored First Baptist Church Canyon Lake, the church sat about a mile west of a bend in the Guadalupe River known as the Horseshoe. The Horseshoe was a popular tubing destination. Around the Horseshoe were several places to rent innertubes and so forth. If the river had plenty of water in it, it would take about 45 minutes to tube the Horseshoe. If the river was low and slow flowing, it could take about two hours.

“Each of us must make a decision to focus on what God is calling us to and how we are to pursue it.”

One of the things I noticed is that not once did I ever see anyone paddling along. I certainly never saw anyone paddling against the flow of the river. The beauty of tubing is that you simply sit in your tube, relax, and let the river carry you downstream. If you are on vacation, and it is blazing hot outside, this is a beautiful thing. However, if it is not a river carrying you downstream, but cultural drift, it is not such a good thing.

We live in a culture that is, for the most part, apathetic toward the things of God. Being accepting and supportive have become far greater virtues than pursuing godliness. The pressure to shift and adapt has never been greater. For many, they would love nothing more than for us to give up our godly convictions and adopt the progressive agenda of our culture.

The question for us becomes, how do I stand firm and avoid drifting down stream with the culture. Today, Paul will answer that question for us. He will show us certain disciplines and mindsets that will help us to stand strong. Each of us must make a decision to focus on what God is calling us to and how we are to pursue it.

It is easy to believe that we live in a culture that is more difficult than ever to stand for Christ. This simply is not true. A quick look at the New Testament Epistles will reveal that there truly is nothing new under the sun. The church has stood in opposition to the culture since the beginning. Instead of being made to believe that it is harder than ever, let us look to scripture to see how it has been done before.

Honored to be your pastor,

DARRELL

TODAY’S WORSHIP

House of the Lord
(Wickham/Smith)

THIS WEEK AT NORTHSIDE

WELCOME & PRAYER

Firm Foundation (He Won’t)
(Carnes/Davis/Moore)

Only A Holy God
(Farren/Smith/Robinson/Thompson)

In Christ Alone
(Getty/Townend)

MESSAGE
How Do I Stand Firm on Shifting Sand?
2 Timothy 3:10-15
DARRELL TOMASEK

TIME OF COMMITMENT

Come As You Are
(Glover/Crowder/Maher)

GIVING OF OUR TITHES & OFFERINGS

Agnus Dei
(Smith)

PARTING BLESSING & PRAYER

CCLI #2234

SERMON NOTES



Asking for a Friend How Do I Stand Firm on Shifting Sand? 2 Timothy 3:10-15

THE BIG IDEA: With the cultural drift that is taking place, we must have a strategic plan to stand firm.

1. Be _____ (v.10).

2. Expect _____ (vs.11-12).

3. Recognize the _____ (v.13).

4. Stay _____ (vs.14-15).

WELCOME TO NORTHSIDE

UP IN OUT
journey ^ together

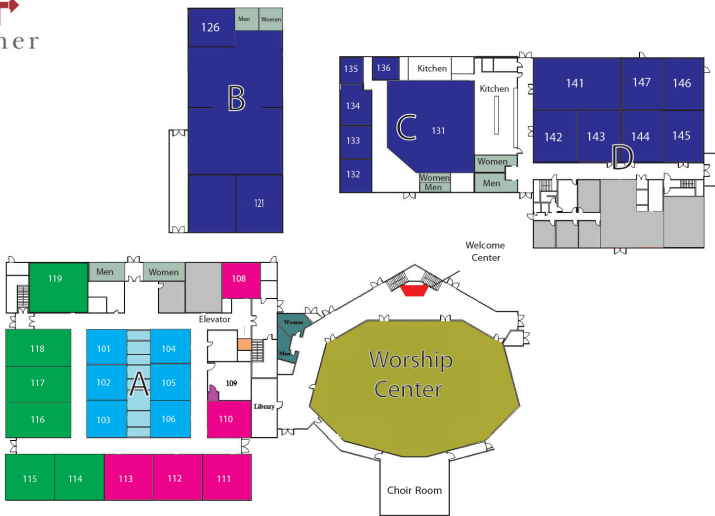

LISTEN ONLINE
Sunday Sermons are
on our website:
nbcvictoria.org



Connect @ Northside

Visit our website @ nbcvictoria.org for:

- Up-to-date Northside happenings
- Online event registrations
- Facebook/ Instagram
- Newsletter

Connect with YouVersion®

1. Open You Version Bible app.
2. Click more.
3. Go to Events and find Northside.

Our guest wi-fi is currently under maintenance. Sorry for any inconvenience.