

MEET OUR STAFF



DARRELL TOMASEK, D.MIN.  
Senior Pastor  
dtomasek@nbcvictoria.org



DEAN MEADE, D.MIN.  
Discipleship Pastor  
deanmeade@nbcvictoria.org



CODY MOORE  
Student Pastor  
codymoore@nbcvictoria.org



DAVE BENEFIELD  
Children's Pastor  
davebenefield@nbcvictoria.org

SHARE THE JOURNEY

GET INVOLVED

- Sunday, June 27
- 9:30a Sunday Morning Bible Study
  - 10:45a Worship Service
  - 10:45a Kid's Church
  - 5:00p Sunday Night Worship Service
  - 5:00p Ecclesia
  - 5:00p Summit Huddle
  - 5:00p GroupLife
  - 6:30p Quarterly Church Conference

- Monday, June 28
- 9:00a Students to Schlitterbahn

- Tuesday, June 29
- 6:00p Zumba Fitness for Women
  - 6:00p Celebrate Recovery

- Wednesday, June 30
- 6:00p Wednesday Night Connect
  - 6:00p Extreme Kids Live
  - 6:00p Student Midweek

- Thursday, July 1
- 6:00p Zumba Fitness for Women
  - 6:00p Trail Life/AHG

- Saturday, July 3
- 5:00p Block Party

**CHURCH SECURITY:** For security purposes, the doors to the church buildings will be open 30 minutes before a service or event. This includes Sunday mornings and Sunday evenings.

(Please note that the calendar was correct at the time of printing. Changes may have occurred after printing that would cause the calendar to be inaccurate.)

COUNT OUR BLESSINGS

Budget Gifts Last Week	\$ 13,255
Given Year to Date	\$ 966,345
Need Year to Date	\$1,085,620

STOPS ON THE JOURNEY

Go to [nbcvictoria.org/wg](http://nbcvictoria.org/wg) for a digital copy of this Worship Guide



**SOUTH TEXAS BLOOD & TISSUE CENTER BLOOD DRIVE**  
Northside will host a Blood Drive on Sunday, July 11, from 8:00am to 1:00pm. You can sign up to donate blood at a Connect Center today. Help save a life by donating blood.

**FIRST IMPRESSIONS TRAINING:**  
Northside will have training for anyone interested in being part of our First Impressions Team. Training is on July 18 from 12:00 - 2:00pm. A box lunch will be provided. Registration is open on our website. Come be a part of one of the most important ministry areas of Northside.

**OVER THE EDGE REGISTRATION DEADLINE**  
The deadline to register for Over the Edge Pre-teen camp is TODAY. Pre-teen camp is for kids completing 3rd - 5th grades. It is a little earlier this year - July 1-5. The cost is \$300. You can contact Dave Benefield if you have any questions. Scholarships available.

**EXTREME KIDS LIVE**  
Don't forget that Wednesday evening at 6:00pm is Extreme Kids Live for kids entering kindergarten through exiting 5th grade.

**OFFICE CLOSED**  
The church office will be closed on Monday, July 5, for the Independence Day holiday.



**JULY 3 AND 4**  
Northside is hosting a Block Party on Saturday, July 3, from 5:00 - 7:00pm on the Upward fields. Come meet the neighbors. There will be hot dogs, games for the kids, music, and lots of visiting. Then on July 4 we are having an Independence Day Celebration with the Ecclesia band, outdoor baptism, hamburgers, and a return of the homemade ice cream contest. This is also from 5:00 - 7:00pm. Mark your calendars.



4100 North Laurent | Victoria, Texas 77901 | 361.578.1568  
[www.nbcvictoria.org](http://www.nbcvictoria.org)



**COSTA RICA MISSION TRIP**  
Northside is sending a group of people to Costa Rica July 22 - 29 for light construction and children's activities. The cost is \$1,400. The deadline for the \$400 non-refundable deposit has been extended. Visit a Connect Center for more information. Call Dean if you have any questions about this trip. We need you.

**QUARTERLY CHURCH CONFERENCE**  
Tonight is Northside's Quarterly Church Conference. Join us at 6:30pm in The Chapel to find out what is happening at Northside.

**WOMEN'S NIGHT**  
Join other women at Northside on Friday, July 9, from 6:00 - 8:00pm for a night of fellowship and diving into the word. Bring your favorite snack to share if you are able. Childcare is available. Register for childcare on the events page of our website by July 8.

**UPWARD FLAG FOOTBALL/CHEERLEADING**  
Registration is open for Upward Flag Football and Cheerleading. The season begins with evaluations on 8/23; 8/28; 8/29; and 9/1. Practices begin the week of September 20. Games are October 2 through November 6. Register on the events tab at [nbcvictoria.org](http://nbcvictoria.org).

**LORD'S SUPPER**  
We will celebrate the Lord's Supper on Sunday, July 11, in the morning worship service. Pre-sealed elements will be used.

**STUDENTS TO SCHLITTERBAHN**  
Students 6th - 12th grade, you're going to Schlitterbahn! Meet at the church on June 28 to depart at 9:00am. We will stay until the park closes at 6:00pm, so we should be back in Victoria by 8:00pm. The cost is \$45. You can register on the events page of our website, [nbcvictoria.org](http://nbcvictoria.org).



JUNE 27, 2021

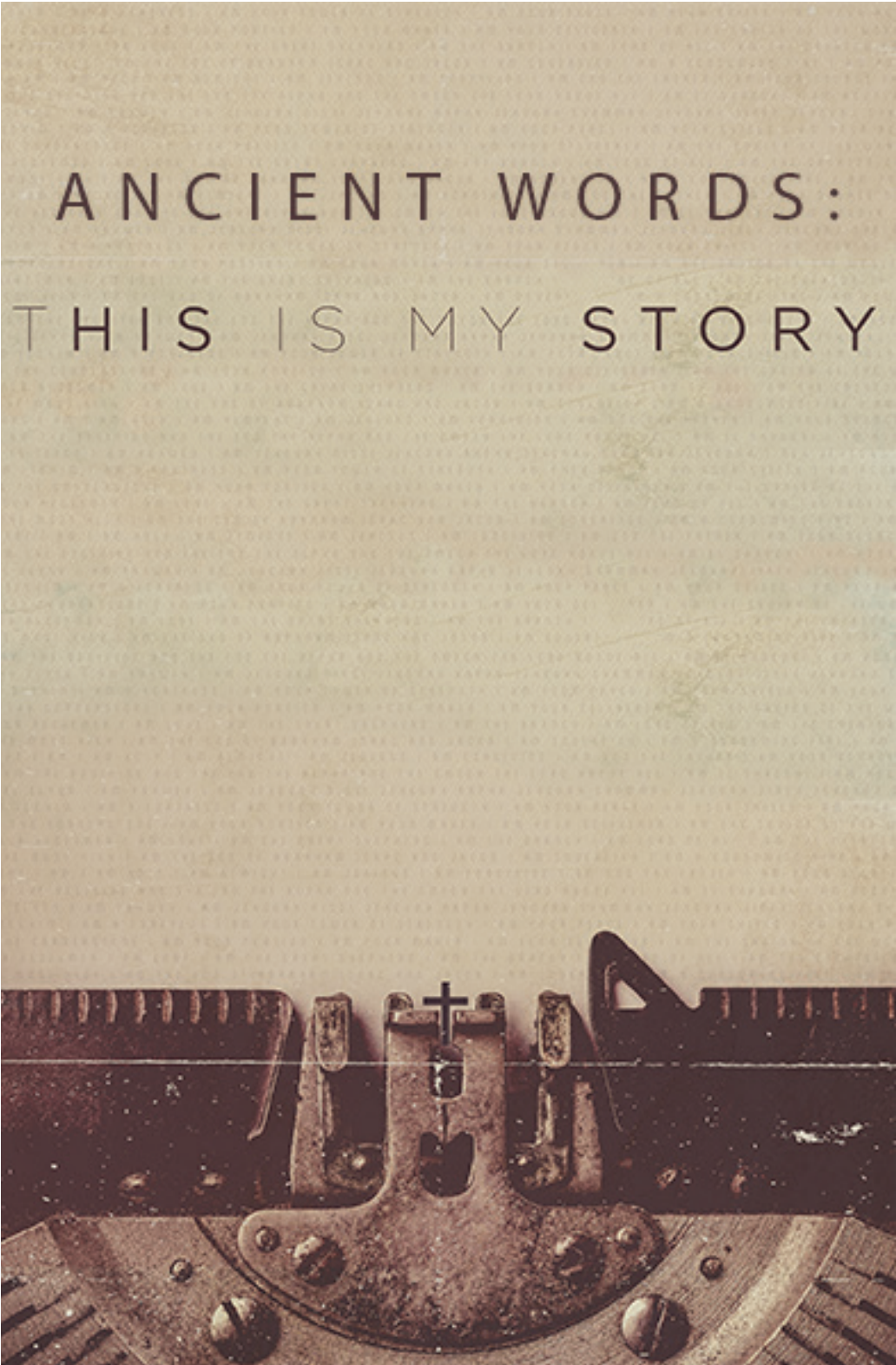

Worship Sundays at 10:45am

MULTI-GEN MULTI-ETHNIC  
journeying ^together



# THOUGHTS ON THE JOURNEY



Julie McElhaney

Habakkuk 3:19

A teenager in rebellion, a Sunday School teacher, and a different translation - the Amplified Bible. That’s how Habakkuk 3:19 became “My Verse”.

My dad was always changing jobs, and we moved all over - even Hawaii. Two kindergartens, 3 high schools, and lots of others in between left me without a foundation of friends or relatives. Sometimes we went to church, sometimes not depending on where we lived and how my dad felt. After 9th and 10th grade in Hawaii and 11th in Oregon I was burnt-out on school for 12th grade in Norman, Oklahoma.

A Sunday School teacher at First Baptist Church became my mentor with horses and Jesus. She used the Amplified Bible and only the Amplified Bible helped me understand the importance of walking onward.

Knowing God is MY strength, MY personal bravery, and MY invincible army. He will make me to walk, not to stand still in terror, and make spiritual progress upon my high places of trouble, suffering, or responsibility. Now at age 68, I’ve learned that these problems can come one at a time or all 3 together. My confidence and trust rest in my heavenly Father, my Lord and Savior, Jesus, and my Comforter, the Holy Spirit. I frequently don’t understand the “why” of life’s trials. I have learned to keep walking, knowing who I believe in. I hope others will see this Old Testament book in a new light and spend some time walking with Habakkuk.

Julie McElhaney

# TODAY’S WORSHIP

*I Saw the Light/I’ll Fly Away*  
(Crowder, arr)

*Do Lord*  
(Frey)

*Leaning On The Everlasting Arms*  
(Hoffman/Showalter)

*’Tis So Sweet To Trust in Jesus*  
(Stead/Hall/Kirkpatrick)

### WELCOME & PRAYER

*How Great Is Our God*  
(Tomlin/Reeves/Cash)

*The Love Of God*  
(Lehman)

**MESSAGE**  
*This is My Story*  
*Ancient Words: The Gripping Agony of Loss*  
Psalm 105:1-6; 2 Samuel 12:15-23  
DARRELL TOMASEK

### TIME OF COMMITMENT

*It Is Well*  
(Spafford/Bliss)

### GIVING OF OUR TITHES & OFFERINGS

*On My Father’s Side*  
(Shirley)  
KIM AND DEBBIE SPRING

### THIS WEEK AT NORTHSIDE

*I Saw the Light/I’ll Fly Away*  
(Crowder, arr)

CCLI #2234

# SERMON NOTES



**Ancient Words: This Is My Story**  
The Gripping Agony of Loss  
*Psalm 105:1-6; 2 Samuel 12:15-23*

**The Big Idea:** The truths learned in the course of life will sustain us in our darkest hour.

1. David \_\_\_\_\_ in prayer (vs. 16-17).
2. David \_\_\_\_\_ himself to the will of God (vs. 18-19).
3. David \_\_\_\_\_ (v. 20a).
4. David \_\_\_\_\_ for his physical needs (v. 20b).
5. David had \_\_\_\_\_ for the future (v. 21-23).

# WELCOME TO NORTHSIDE

**UP IN OUT**  
journey together

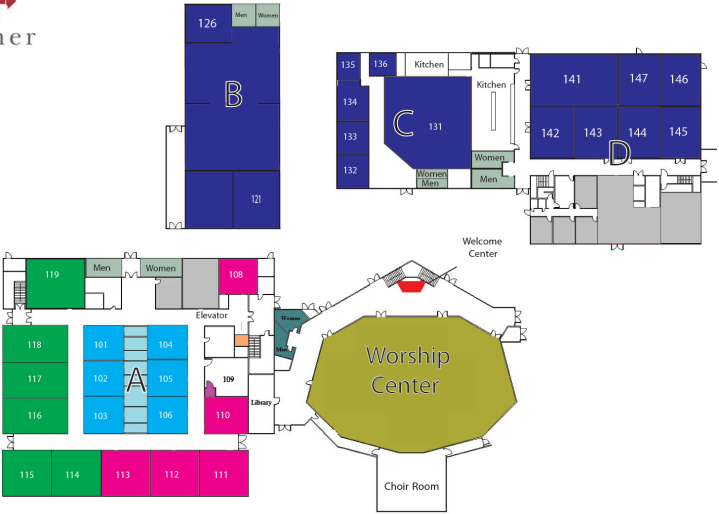

LISTEN ONLINE  
Sunday Sermons are  
on our website:  
[nbcvictoria.org](http://nbcvictoria.org)



## Connect @ Northside

Visit our website @ [nbcvictoria.org](http://nbcvictoria.org) for:

- Pastor’s Blog
- Up-to-date Northside happenings
- Online event registrations
- Facebook
- Newsletter

## Connect with YouVersion®

1. Open *You Version Bible* app.
2. Click more.
3. Go to Events and find Northside.

To get wi-fi in the Worship Center, choose the *northside mar* network. The password is *john 316*.

**@ THE FRONTLINE**

1. Have you ever known loss?
2. What was that experience like?
3. What role did the word of God play in your accepting that loss?
4. What scripture would you point someone to who is experiencing loss?