

MEET OUR STAFF



DARRELL TOMASEK, D.MIN.
Senior Pastor
dtomasek@nbcvictoria.org



DEAN MEADE, D.MIN.
Discipleship Pastor
deanmeade@nbcvictoria.org



CODY MOORE
Student Pastor
codymoore@nbcvictoria.org



DAVE BENEFIELD
Children's Pastor
davebenefield@nbcvictoria.org

SHARE THE JOURNEY

GET INVOLVED

Sunday, May 23

- 9:30a Sunday Morning Bible Study
- 9:30a Worship Service
- 11:00a Sunday Morning Bible Study
- 11:00a Worship Service
- 11:00a Kid's Church
- 5:00p GroupLife
- 5:00p Sunday Evening Worship
- 5:00p Summit Huddle
- 5:00p Ecclesia

Tuesday, May 25

- 6:00p Celebrate Recovery

Wednesday, May 26

- 6:00p Wednesday Night Connect
- 6:00p Extreme Kids Live
- 6:00p Student Talent Show
- 7:00p Worship Choir Rehearsal

Thursday, May 27

- 6:00p Zumba Fitness for Women
- 6:15p Trail Life

CHURCH SECURITY: For security purposes, the doors to the church buildings will be open 30 minutes before a service or event. This includes Sunday mornings and Sunday evenings.

(Please note that the calendar was correct at the time of printing. Changes may have occurred after printing that would cause the calendar to be inaccurate.)

COUNT OUR BLESSINGS

Budget Gifts Last Week	\$ 14,793
Given Year to Date	\$ 845,377
Need Year to Date	\$ 925,970

STOPS ON THE JOURNEY

Go to nbcvictoria.org/wg for a digital copy of this Worship Guide



MISSION: POSSIBLE - POSTPONED
The Praiz Kids musical, *Mission: Possible*, has had to be postponed. Watch the newsletter and worship guide for the new date and time. Don't miss this musical that shows you that your mission field is closer than you think. These kids have been learning about worship and God all year. Come hear what they have learned.

EXTREME KIDS LIVE
Wednesday evenings are full of exciting fun beginning May 19 because that is when Extreme Kids Live returns. Kids entering kindergarten through exiting 5th grade can join Pastor Dave at 6:00pm for radical fun. Bring your friends. You won't want to miss this!

MASKS OPTIONAL
Northside has gone to "masks optional". Please be considerate to those who don't agree with your choice.

VALLEY MISSION TRIP
We are returning to the Rio Grande Valley June 5 - 8 for another construction project. Please contact Pastor Dean if you are interested in going on this trip.

ONE WORSHIP
Northside will return to one worship service beginning June 6. Sunday School will begin at 9:30am with worship at 10:45am.



WOMEN'S NIGHT
Join other women at Northside on Friday, June 11, from 6:00 - 8:00pm for a night of fellowship and diving into the word. Bring your favorite snack to share if you are able. Childcare is available. Register for childcare on the events page of our website by June 10.

VBS VOLUNTEERS
If you have signed up to volunteer for Vacation Bible School, you need to come to a short meeting on Sunday, May 30, right after the 11:00am worship service. The meeting is in Building D. Please contact Pastor Dave if you **cannot** make this meeting.

OVER THE EDGE
Over the Edge Pre-teen camp registration is now open. Pre-teen camp is for kids completing 3rd - 5th grades. It is a little earlier this year - July 1-5. The cost is \$300. You can contact Dave Benefield if you have any questions.

MAY CALENDAR
There will also be no evening activities on Sunday, May 30. The church office will be closed May 31 for Memorial Day.



LOST AND FOUND
Please check the Welcome Center for anything you may have lost here. Items will be tossed at the end of May. We have sunglasses, keys, cups, etc.

VACATION BIBLE SCHOOL
VBS registration is open on our website event tab. VBS is June 13 - 17 from 6:00pm to 8:30pm. Exiting Kinder through 4th grade are invited to attend.

We have a separate VBS for 5th grade. It is the same date and time, just a little different. Register for Merge on our website.

VBS SUPPLIES
We are planning on hosting about 200 kids for Vacation Bible School. That means snacks. Pick up a donation card at a Connect Center today. Bring the item listed on the card back to a Connect Center or the church office by June 6. Your donations really help.



MAY 23, 2021



THOUGHTS ON THE JOURNEY

The single most important question we can answer is the question Jesus asks Peter. Jesus asked him, “Who do you say that I am?” What is your answer to that question? Is Jesus just a good teacher? Was He just a prophet? Is He just a good man? Or, is Jesus the Christ, the Savior of the world?

Our answer to this question will impact everything about us. It will affect the way we live our lives, our priorities, and even our goals. If Jesus is just a good man, or a good teacher, or even a prophet – then it really requires nothing of us. But, if Jesus is the Christ, then we have to rethink everything.

Today we will see the lives of several people who are around Jesus. Not only do we see these people, but we see how their relationship with Jesus affects their lives. For those who believed in Jesus, He becomes a central influence for them. We see it first in the people who brought the blind man to Jesus. They bring him and beg Jesus to touch Him. If they did not believe Jesus had such power, they would not have wasted their time.

We see still others who did not fully understand who Jesus was. When pressed, they would say that he was John the Baptist, or Elijah, or one of the prophets. They had not yet fully understood who Jesus was, so they explained Him away and moved on with their lives.

Then we see the disciples. These are men who had been with Jesus. These men had seen him teach and had seen the miracles. In time they had made a determination for themselves as to who Jesus was. When pressed, their answer was that Jesus was the Christ. Their simple statement was filled with implications. If Jesus was the Christ, it changed everything.

So, we end where we began. To you, who is this Jesus? If He is the Christ, it changes everything. If He is not, you can dismiss Him and move forward with your life. But, be careful, this is the most important question you will ever answer.

Honored to be your pastor,

DARRELL

TODAY’S WORSHIP

At Calvary
(Newell/Towner)

WELCOME & PRAYER

Good Good Father
(Brown/Barrett)

Goodness of God
(Johnson/Ingram/Fielding/Cash/Johnson)

God You’re So Good
(Younker/Stansfill/Ligertwood/Ligertwood)

MESSAGE
The Gospel of Mark: Who Do You Say I Am?
Mark 8:22-30
DARRELL TOMASEK

TIME OF COMMITMENT

Build My Life
(Redman/Martin/Kaple/Barrett/Younker)

GIVING OF OUR TITHES & OFFERINGS

The Prayer
(Sager/Foster)
RANDY & DONNA HUDSON

THIS WEEK AT NORTHSIDE

Goodness of God
(Johnson/Ingram/Fielding/Cash/Johnson)

CCLI #2234

SERMON NOTES



Who Do You Say I Am? Mark 8:22-30

THE BIG IDEA: Becoming a disciple is not based on a momentary decision but is rooted in an ongoing relationship.

1. Discipleship requires _____ and _____ (v. 22).
2. Discipleship requires _____ (vs. 23-26).
3. Discipleship requires a definitive _____ (v. 27-29).
4. Discipleship requires _____ (v. 30).

WELCOME TO NORTHSIDE

UP IN OUT
journey ^ together

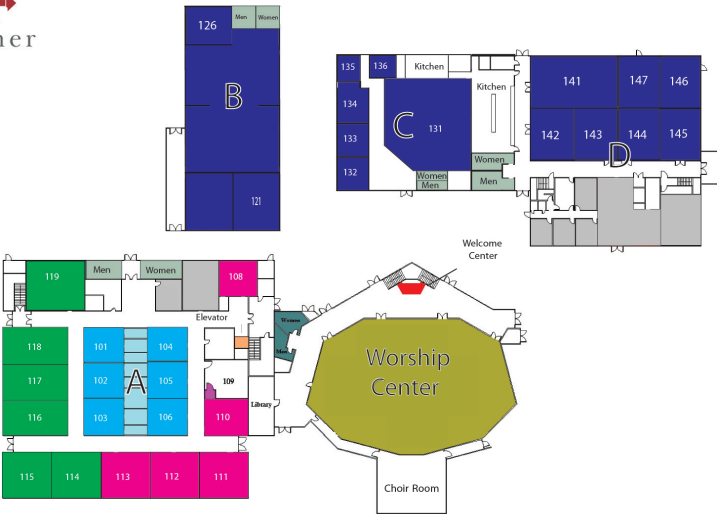

LISTEN ONLINE
Sunday Sermons are
on our website:
nbcvictoria.org



Connect @ Northside

Visit our website @ nbcvictoria.org for:

- Pastor’s Blog
- Up-to-date Northside happenings
- Online event registrations
- Facebook
- Newsletter

Connect with YouVersion®

1. Open *You Version Bible* app.
2. Click more.
3. Go to Events and find Northside.

To get wi-fi in the Worship Center, choose the *northside mar* network. The password is *john 316*.



1. To you, who is Jesus?
2. Over the course of time, how have you grown in your relationship with Him?
3. How have you prepared yourself to tell others about what He means to you?
4. How would you rate your passion level as it relates to prayer and sharing?