



SUNDAY SCHOOL

CLASSES

YOUNG & MEDIAN ADULTS

YOUNG ADULTS 1

Average Age: 28

Class Description: *This class focuses on deep, biblical, exegetical teaching. You can expect engaged and newly married couples, some with children.*

Director: Levi Mattes - levi.mattes@gmail.com

Director: Garrett Weir - garrett.weir17@gmail.com

Teacher: Pastor Philip Jackson - pjackson@evergreenbc.org

Location: A112 / **Time:** 9:00am

YOUNG ADULTS 2

Average Age: 22

Class Description: *College, young singles, and early career adults searching the Bible for the answers to "What do I believe?" and "How do I live that out?"*

Director: Abigail Gabbert - abigailw247@hotmail.com

Teacher: Pastor Taylor Gabbert - tgabbert@evergreenbc.org

Location: A102 / **Time:** 9:00am

YOUNG ADULTS 3

Average Age: 25

Class Description: *This class is for engaged and newly-wed couples, where we'll focus on exegetical teaching and spiritual disciplines through the lens of marriage. Two become one in marriage, so let's learn how to lean into that in our personal discipleship and how we build our families.*

Director: Nick Buford - nicholas@nabuford.com

Director: Anna Buford - analesse.mounts@gmail.com

Teacher: Pastor Matt O'Mealey - momealey@evergreenbc.org

Teacher: Keeva O'Mealey - keeva.marie@gmail.com

Location: A123 / **Time:** 9:00am

MEDIAN ADULTS 1

Average Age: 53

Class Description: *This is an open class for singles and couples of any age. Harry Layden is the teacher. The class is also streamed each week via Zoom for members that are out sick or traveling.*

Director: Chuck Mason - cmason3@cox.net

Teacher: Harry Layden - harrylayden@gmail.com

Location: A202 / **Time:** 9:00am

MEDIAN ADULTS 2

Average Age: 40

Class Description: *This class welcomes everyone to join, both couples and singles! Join this class to be a part of exegetical teaching with lots of open discussion.*

Director: Terri Willms - terri@gnosko.net

Teacher: Brian Willms - brian@gnosko.net

Location: A208 / **Time:** 9:00am



EvergreenChurch





SUNDAY SCHOOL

CLASSES

MEDIAN ADULTS

MEDIAN ADULTS 4

Average Age: 50

Class Description: *This class is open to all seasons of life as it consists of a wide variety of attendees. The class uses the Explore the Bible literature for the weekly lessons. This class has fellowships such as a December Christmas party and enjoys S.M.A.C.K (Sunday Meal After Church with or without Kids) together about once per quarter.*

Director: Billy Hawley - billy.hawley@yahoo.com

Teacher: Amy Hawley - ahwaley@evergreenbc.org

Location: A210 / **Time:** 9:00am

MEDIAN ADULTS 5

Average Age: 55

Class Description: *This class utilizes the Lifeway Quarterly Curriculum, Explore the Bible, which focuses on individual books of the Bible. It is teacher led with group discussion and enjoys regular fellowships.*

Director: Nathan Culberson - nculberson68@gmail.com

Teacher: Ed Coffman - ejcoffman2@gmail.com

Teacher: Ken Pewthers - krpewthers@gmail.com

Location: A206 / **Time:** 9:00am

MEDIAN ADULTS 6

Average Age: 62

Class Description: *This class of adults consists of a wide age-range, mainly "empty nesters." This class, who feels more like family, loves the Lord and actively seeks to learn Biblical truths and grow in the Lord through the teaching of His word.*

Director: Donna Ellard - dellard@evergreenbc.org

Teacher: Matt Ellard - mattellard05@gmail.com

Location: A227 / **Time:** 10:30am

MEDIAN ADULTS 7

Average Age: 40

Class Description: *This is an open class that has a wide age range of adults, both singles and marrieds. You can expect to find exegetical teaching and class discussion throughout various books of the bible as to seek out what it means to live the Christian life. Fellowship and community are also a large part of this class.*

Director: Kaylie Tollett - kaylie.fitz96@gmail.com

Director: James Tollett - jamesdtollett@gmail.com

Teacher: Pastor AJ Gonzalez - agonzalez@evergreenbc.org

Teacher: Ashley Gonzalez - ashley-watson@utulsa.edu

Location: A227 / **Time:** 9:00am



EvergreenChurch



SUNDAY SCHOOL

CLASSES

SENIOR ADULTS

SENIOR ADULTS 1

Average Age: 80

Class Description: This class, made up of our most senior adults, is teacher led with group discussion through the Lifeway Material, Exploring the Bible. This class enjoys strong friendships, regular fellowships, and donuts monthly.

Director: Mark DeClerk - drmrpd@gmail.com

Director: Cassandra DeClerk - (918) 625-6876

Teacher: Ron Thornton - ronthornton813@gmail.com org

Location: A106 / **Time:** 10:30am

SENIOR ADULTS 2

Average Age: 75

Class Description: This is a large class of senior adults who treat each other as family and have multiple teachers for a variety of teaching styles as they study God's Word.

Director: Terry Hale - tlhale52@aol.com

Director: Debbie Hale - tlhale52@aol.com

Teacher: Jim Funck - jhfunck697793@gmail.com

Teacher: Mark Hildebrand - mhildy2@yahoo.com

Teacher: Bob Henderson - stainlessman@icloud.com

Location: A102 / **Time:** 10:30am

SENIOR ADULTS 3

Average Age: 70

Class Description: This class has multiple teachers and teaches from the Lifeway Curriculum. By having multiple teachers, attendees can expect verse-by-verse exposition of the lesson text from various teaching perspectives.

Director: Steve Harkey - steve.harkey@cox.net

Director: Sharon Harkey - sharonharkey58@gmail.com

Teacher: Joe Fears - jfears@barberbartz.com

Teacher: Mike McCormick - msmccormick@olp.net

Location: A210 / **Time:** 10:30am

SENIOR ADULTS 4

Average Age: 63

Class Description: This class consists of mature couples and singles, bound together by our love for the Lord, His Word, and His people. They frequently fellowship with bimonthly lunches, coordinated class projects, and more. The class enjoys growing in the knowledge and wisdom of God with Bible teaching that includes class discussions. This is a group which feels free to share tears of sorrow and joy or just laugh about the experiences they have.

Director: Susan McCoy - smccoy10@cox.net

Teacher: Phil McCoy - pmccoy@bokf.com

Teacher: Mark Shumaker - cmshoe68@olp.net

Location: A225 / **Time:** 9:00am

SENIOR ADULTS 5

Average Age: 64

Class Description: This class is made up of women of all ages and stages of life; married, divorced, single, and/or widowed. This is a community of ladies who deeply love, support, and pray for each other.

Director: Marjie Carr - marjecarr@gmail.com

Teacher: Marjie Carr - marjecarr@gmail.com

Location: A204 / **Time:** 9:00am

SENIOR ADULTS 6

Average Age: 75

Class Description: This class focuses on developing a family atmosphere that will help the class grow in their love for God and their love for each other as they go through life together.

Director: Mel Garner - mel.garner@windstream.net

Director: Sharon Garner - skgarner1025@windstream.net

Teacher: Garry Haskins - ghaskins@hotmail.com

Teacher: Dennis Huddleston - dchuddle@juno.com

Location: A123 / **Time:** 10:30am



EvergreenChurch

EVERGREEN SUNDAY SCHOOL
9:00 AM

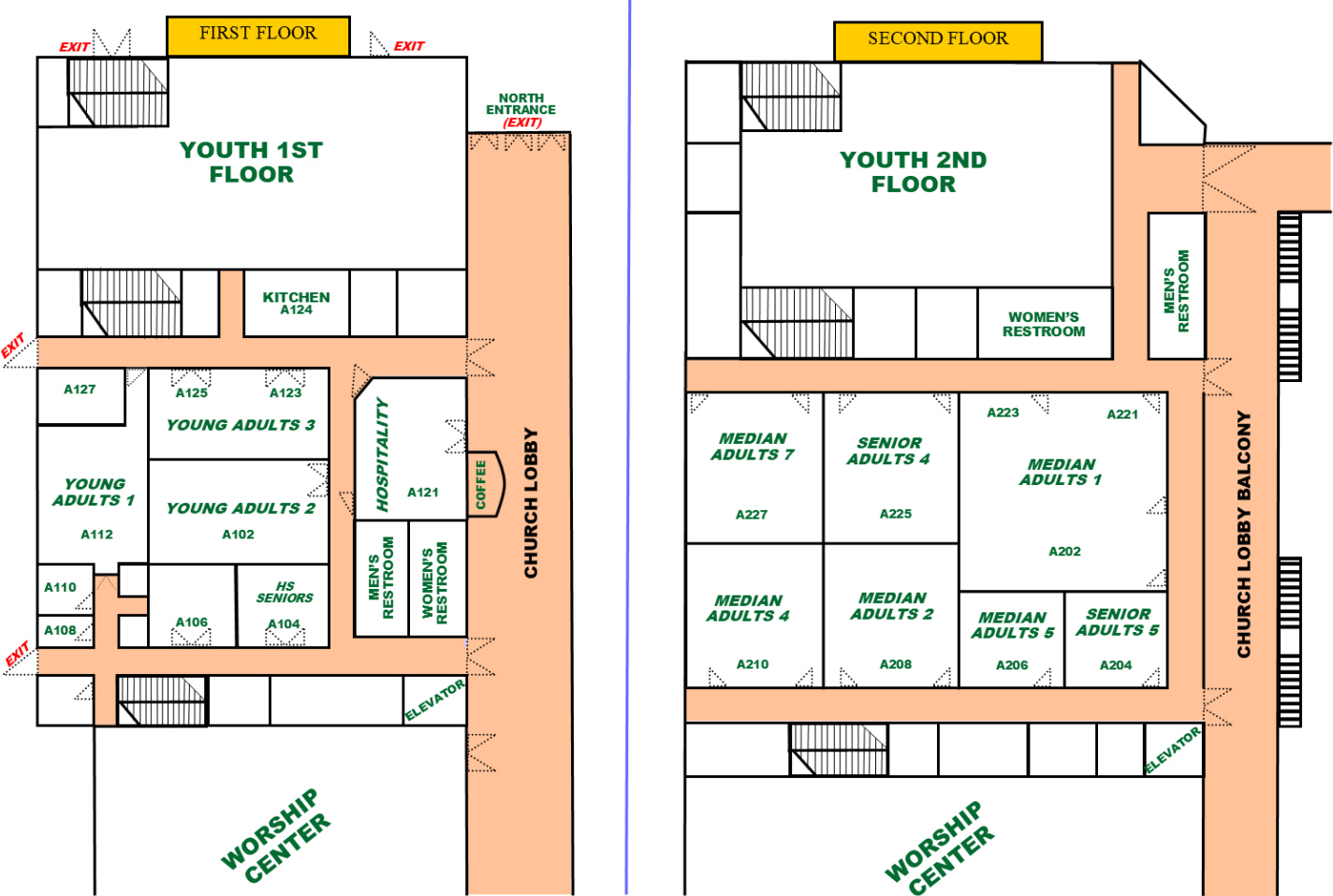

EVERGREEN SUNDAY SCHOOL

10:30 AM

