

## *Dear Church Family,*

From the founding of our city, First Baptist Church Groesbeck has been a vital part of the community, leading the way in reaching people for Christ and growing thriving families. We stand on the shoulders of those who came before us, whose faith and generosity fueled the mission and ministry of Jesus. As buildings were needed, they walked together in faith, giving sacrificially as they were led by Christ so that the work was completed without significant debt.

In recent years we have experienced a season of increasing spiritual health and steady numerical growth—dozens of salvations and baptisms; believers maturing in their faith; members serving others and engaging in missions from the streets of Groesbeck to the other side of the globe. I could not be more proud to be your pastor. Now is the time for us, in our generation, to lead the way. Future generations are depending on our faithfulness.

We stand in a strategic position to take a major step of faith as God has given us a new vision that will serve the present and future needs of our church as well as expand our community outreach. Our present facilities have served us well for decades, but they are showing their age. While renovating space would provide short-term solutions, now is the time to take proactive steps by constructing a new, multi-purpose building as a ministry tool impacting future generations. We anticipate this Family Life Center will include a full-size gym, commercial kitchen, stage, and classroom spaces. It would multiply our ability to host churchwide gatherings, community events, evangelistic outreach, sports ministries, joint worship services, regional church training opportunities, and more.

What an exciting season we are in as a church! I'm reminded of Samuel's words upon calling God's people to walk in obedience to the Lord: "Even now, take your stand and see this great thing which the Lord is going to do before your eyes" (1 Samuel 12:16). A project of this magnitude will be a major step of faith for us as a congregation. As we begin this faith journey together, we must align our hearts with the Lord through prayer. Each of us must seek Him and find the measure of sacrificial obedience to which He is calling us. We are trusting God to continue to move and provide in mighty ways. He will do so through the faithful generosity of His people. God has placed you in First Baptist Groesbeck at this moment in history for a reason. I urge you to join the movement of God with us. May the Lord richly bless you as you follow Him.

Let's *Lead the Way!*

*Pastor Keith*

# VISION

## A NEW FAMILY LIFE CENTER

- 18,271 Square feet
- Commercial Kitchen
- 7,683 square-foot gymnasium for sports ministries and events
- Potential temporary worship service location
- Portable bleacher seating
- Gym holds event tables or chairs
- 4 medium-sized classrooms
- Multiple storage areas
- Covered drive for easy drop-offs and pick-ups
- Additional parking on either side of new building
- Rear garage addition to provide heavy equipment storage and insulation of passing train noise
- Potential uses as warming center or disaster relief staging area
- Ability to host large regional and local events

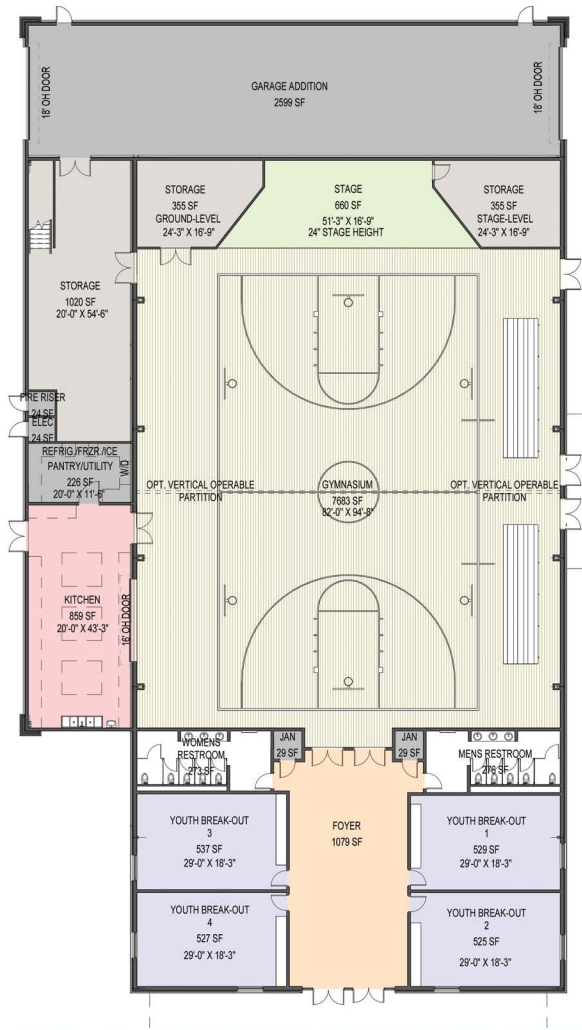

# EVENT CALENDAR

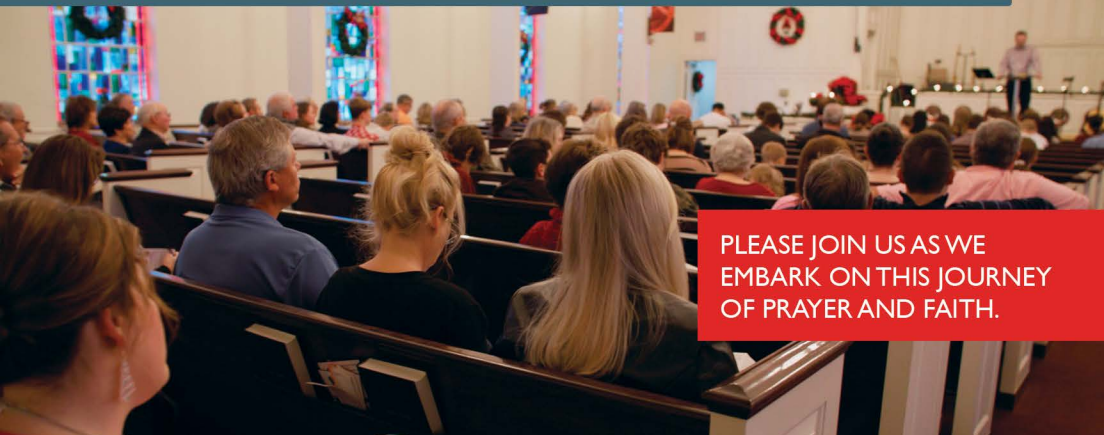

PLEASE JOIN US AS WE  
EMBARK ON THIS JOURNEY  
OF PRAYER AND FAITH.

## *Lead* THE WAY

SUN JANUARY 18<sup>TH</sup>  
Campaign Launch

JANUARY 19<sup>TH</sup> - FEBRUARY 27<sup>TH</sup>  
40 Days of Prayer and Fasting

JANUARY 25<sup>TH</sup> - FEBRUARY 15<sup>TH</sup>  
God's Economy Classes

JANUARY 26<sup>TH</sup> - FEBRUARY 8<sup>TH</sup>  
Focus Groups

FRI FEBRUARY 27<sup>TH</sup> - SAT FEBRUARY 28<sup>TH</sup>  
Prayer Vigil, 6:00PM - 6:00PM

SUN MARCH 22<sup>ND</sup> & 29<sup>TH</sup>  
Pledge Sundays

SUN MARCH 29<sup>TH</sup>  
Celebration Sunday

# HOW CAN I HELP?



## PRAYER SUPPORT

Pray! It is imperative that we cover this whole campaign in prayer. We will be encouraging everyone to participate through times of prayer and fasting over a 40-day period. Also, there will be information about how you can join an intense 24-hour prayer vigil.



## FINANCIALLY

We ask people to prayerfully discern giving outside their normal tithes and offering in both of these ways:

- A one-time “first fruits.” This is giving that is available immediately.
- Pledges: These are monthly pledges to provide support for a three-year period.

## SPREAD THE WORD

Get your friends, family, and the community excited about what God is doing at FBC Groesbeck! Share with them this vision of our LEAD THE WAY campaign. God may lay it on their hearts to be a part of this vision as well!



# FREQUENTLY ASKED QUESTIONS

**When does the campaign begin and what is its purpose?** The campaign begins on Sunday, January 18, with 40 days of prayer and fasting and will conclude with a celebration Sunday at church on March 29, where totals will be announced. The purpose of this campaign is to raise funds to build a family life center to increase our community reach.

**How much will the improvements cost?** We have designed the improvements and are entering the process to getting a precise bid. Our estimated improvements range at \$4.5M to \$5.5M depending on finishes selected.

**How will the funds be raised?** Funds will be raised in a variety of ways. There will be church family aspect of Lead the Way where each of us will be invited to go on a prayer journey and prayerfully consider how we might financially participate; the congregation will pledge on March 22. This is a step of faith, and we all get a front row seat to watching the Lord bless.

**If I decide to give, how long would I be making this pledge?** The duration of the giving period will be three years, however, donations can also be a one-time gift.

**What if my financial situation changes after I make my commitment?** While we hope that won't happen for you, we understand that the future is unknown. If your situation changes, you and your family would determine the most appropriate response. As this is a commitment between you and the Lord, we trust you will prayerfully work through it with the Lord.

**Will I get a tax receipt for my donations?** Yes, all funds donated to the *Lead the Way* fund will receive the same tax receipting as any other giving to FBC Groesbeck.

# FREQUENTLY ASKED QUESTIONS

**How can I help with or fully participate in this?** We ask that you join us in prayer, as God is the one who will ultimately provide for His church. Prayer is not the only thing that we will do, but it must be the first thing. Join us in our “40 days of Prayer and Fasting” that begins Monday, January 19, but also join us for the upcoming “24-hour Prayer Vigil” on February 27 & 28. More information on the Prayer Vigil will be coming soon!

**Can my employer match my gift if they have a matching program?** The business would receive a donation receipt for tax purposes the same as an individual donor. You may need to look at the regulations for your employer's matching funds. We would be happy to help however we can.

**Is this commitment/pledge in addition to my regular giving?** Yes. We're asking that whatever you pledge for the 3-year-period would be over and above your normal giving. We use the General Operating Fund, where your normal tithes and offerings are placed, for the day-to-day operations, ministries, and missions of the church. The funds pledged for Lead the Way will be placed in a separate fund to be used solely for the purposes listed above.

**Where can I get further information about the *Lead the Way* campaign?** Pastor Keith and his team will be visiting several small gatherings between January 26 through February 9, so that you can hear more and ask questions. We will be sharing location and times for these gatherings so more info to follow. If none of the times work for you or you would like to talk with someone one-on-one, please feel free to contact Pastor Keith ([kcollier@fbcgroesbeck.com](mailto:kcollier@fbcgroesbeck.com))



# Lead THE WAY

PASTOR  
KEITH COLLIER

CAMPAIGN DIRECTOR  
CHARLES EASTBURN

PRAYER TEAM  
LARRY SLOAN

EVENTS  
LEA HARDISON

ADMIN  
AMIE GHORMLEY

SCAN TO DONATE



*You can make  
a difference.*

## WAYS TO GIVE



### DONATE

Make a one-time gift or set up a recurring pledge by scanning the QR code above with your phone.



### CHECK

A check with "Lead the Way" in the memo line can be mailed to:

FBC Groesbeck  
306 N Ellis St  
Groesbeck, TX 76642



### PARTNER

We'd love to know if your business is interested in supporting our LEAD THE WAY campaign.

Email us at:  
[info@fbcgroesbeck.com](mailto:info@fbcgroesbeck.com)



**FIRST BAPTIST  
GROESBECK**  
LIFE. FAMILY. MISSION.

**FBCGroesbeck.com**

[info@fbcgroesbeck.com](mailto:info@fbcgroesbeck.com)  
254-729-5120  
306 N Ellis St  
Groesbeck, TX 76642